



Coated, Bonded & Non-Woven
Product Catalog & Reference Guide



For More Information

For more information on our Standard Abrasives offering, visit www.standardabrasives.com



Notes and Key Contacts:

About this Guide



Applications & Comparisons

This catalog contains detailed information about Standard Abrasives™ coated abrasive specialties, bonded and non-woven products, with particular emphasis on applications and operating tips.

Availability

The most popular items are stocked for immediate shipment, and are listed as Key Items in the Standard Abrasives Price Book.

Money-Saving Tips:

Help reduce costs across the supply chain by following recommended buying strategies designed to eliminate inefficiencies and reduce operating expenses:

- **Order in full case quantities:**

- Reduce inventory-tracking costs.
- Reduce number of orders.
- Reduce handling time.

- **Order the most popular products – Key Items:**

- Key items can cost less than non-stock “MTO” (Made-to-Order) items.
- Key items may require a lower minimum ordering quantity.
- Key items have shorter lead times for fastest delivery.

Coated	
Belts, Coated Abrasive File	12
Cartridge Rolls, Precision	25
Cartridge Rolls, Straight, Tapered & Sidewall. 22-24	
Discs, Flap.....	16
Discs, PSA.....	20-21
Discs, Quick Change, Fiber.....	10
Discs, Quick Change TS, TR, TP	5-11
Discs, Resin Fiber.....	13-15
Flap Wheels, Flexible	19
Flap Wheels	17-18
Rolls, Handy.....	28
Sheets, Cloth and Paper.....	28
Spiral Bands, Resin Bond	26
Pads, Abrasive Square & Cross	27
Bonded	
Wheels, Cut-Off.....	29
Hardware	
Adapters, Flange.....	48,58
Adapters, Flap Wheels	18,19
Bushings, Reducer, Flap Wheels	18,19
Drums for Spiral Bands and Surface	
Conditioning Bands	26,37
Holder for Hand Pads.....	53
Holder Pads, Buff & Blend Discs	44
Holder Pads, Cleaning Discs	54
Holder Pads, Felt Polishing Discs.....	51
Holder Pads, Hook & Loop Style.....	34,44
Holder Pads, Low Profile	11,54
Holder Pads, PSA Discs.....	21
Holder Pads, Resin Fiber &	
Large Diameter Discs.....	15,44
Holder Pads, Quick Change Discs,	
TS, TR & TP Styles	11
Holder Pads, Surface Conditioning Discs	33-34
Holder Pads, Unitized Wheels, TS.....	61
Mandrels, Cartridge Rolls.....	24
Mandrels, Unitized Wheels.....	65
Mandrels & Pad Adapters.....	11,15,27,32,33,35,40,44,45,49,54
Miscellaneous	
Kits.....	69-70
Competitor Cross-Over Comparison Chart.....	71

Non-Woven	
Buff & Blend Products:	
Buff & Blend Materials Performance	
& Common Applications.....	39
Circle Buffs, GP	45
Combi-Wheels.....	46
Cross Buffs	49-50
Discs, AP	43
Discs, GP	40
Discs, High Strength	41-42
Discs, High Strength Medium Type F.....	42
Discs, HP	42
Flap Brushes	48
Flap Brushes, Mini	47
Flap Brushes, Mounted	46
Rolls	51
Wheels, GP & High Strength.....	45
Convolute Products:	
Convolute Materials Performance	
& Common Applications.....	55
Wheels, Convolute (Deburring).....	58
Wheels, Convolute (General Purpose).....	57
Wheels, Convolute (GP Plus).....	56
Wheels, Convolute (LDW - Light	
Deburring Wheel)	58
Wheels, Convolute (Metal Finishing)	56
Wheels, Convolute (Multi-Finish)	57
Discs, Cleaning	54
Discs, Felt Polishing.....	51
Hand Pads & Power Pads	52-53
Surface Conditioning Products:	
Surface Conditioning Materials Performance	
& Common Applications.....	30
Belts, FE & RC.....	36-37
Bands, RC.....	37
Discs, Bristle	38
Discs, FE, GP, RC & XD	31-34
Stars.....	35
Unitized Products:	
Unitized Materials Performance	
& Common Applications.....	59
Discs, Type 27 Unitized.....	67
Unitized Mounted Points	68
Unitized Wheels (All Densities).....	60-66

Standard Abrasives™ Quick Change Discs for Disc Sanders

Choice of Quick Change Attachments

The Standard Abrasives brand offers three quick change attachment styles. Each offers fast disc changes, a centered disc and is smooth running to help reduce operating expenses and increase productivity by providing the most value and use out of every disc.

Variety of Abrasive Grains

Standard Abrasives Quick Change Discs for disc sanders are available in a choice of grains best suited for a variety of industrial applications:

A/O (Aluminum Oxide) – Fast cut rate, all-purpose versatility.

A/O Extra – High stock removable on difficult to grind and heat-sensitive metals.

Silicon Carbide – Sharp cutting points provide rapid cutting action; best on non-ferrous metals.

Zirconia Pro – Cool running on stainless for extended stock removal; best performance when medium to heavy pressure is applied. Very durable.

Ceramic – Cool cutting action reduces loading risk and discoloration, best on stainless and high nickel alloys.

Ceramic Pro – Great stock removal on flat surfaces; best for aluminum and stainless steel.

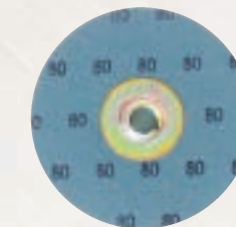

Quick Change TS System was introduced in 1959 as the SocAtt original metal-to-metal quick change sanding system. Now called the TS System, it remains the most popular style for safety, productivity and fast disc changes. Change discs by simply twisting to unlock the disc from the holder pad.

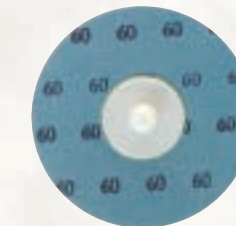

Quick Change TR System (formerly known as Lockit) features a common nylon threaded male (screw type) hub. Easily mounts to TR or Roloc™ type holder pads holder pads with a half turn. Stays securely in place for the life of the disc.



Quick Change TP System (formerly known as ClickOn) features a snap-on/snap-off nylon fastening hub. Allows for quick disc changes when working on mild contours, as well as flat surfaces. Mounts to TP or Power-Lock™ Type I holder pads.

QUICK CHANGE COATED ABRASIVE DISCS

	MINERAL					
	GOOD		BETTER	BEST		
	A/O	A/O EXTRA	SILICON CARBIDE	ZIRCONIA PRO	CERAMIC	CERAMIC PRO
PRODUCT APPLICATIONS						
MRO	•	•				
GRIND	•	•	•	•	•	•
HEAT-SENSITIVE		•		•	•	•
DEBURR	•	•	•	•	•	•
BLEND	•		•			•
FINISH			•			•
MATERIALS						
FERROUS	•					
NON-FERROUS			•			
ALUMINUM		•		•		
HIGH NICKEL/CHROME ALLOYS		•			•	•
STAINLESS STEEL		•		•	•	•
TITANIUM			•			•
COMPOSITES	•			•		
PRESSURE APPLICATIONS	LOW	LOW	LOW	MED-HIGH	HIGHEST	HIGHEST

Most Quick Change Coated Abrasive Discs are available in TS, TR and TP attachment systems. Call for availability.

QUICK CHANGE ALUMINUM OXIDE DISCS – continued

Quick Change A/O Extra Discs, 2 Ply

- Ideal for flat or contoured surfaces
- Good for difficult to grind metals such as aircraft grade Aluminum, High Nickel, Chrome Alloys, & heat-sensitive metal
- Includes grinding aid

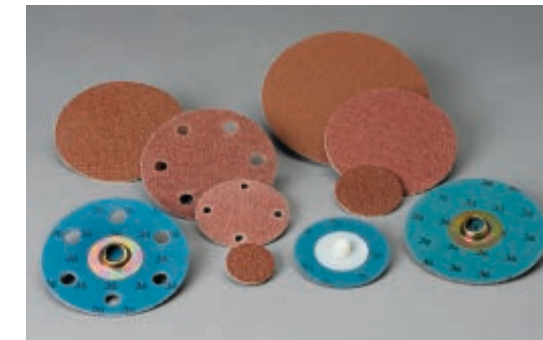

GRADE	3/4"		1"		1 1/2"		2"		3"	
	TS PART NO.	TR PART NO.	TS PART NO.	TR PART NO.	TS PART NO.	TR PART NO.	TS PART NO.	TR PART NO.	TS PART NO.	TR PART NO.
36	522152	–	522252	592252	522352	592352	522452	592452	522552	592552
40	522153	–	522253	592253	522353	592353	522453	592453	522553	592553
50	522154	–	522254	592254	522354	592354	522454	592454	522554	592554
60	522155	–	522255	592255	522355	592355	522455	592455	522555	592555
80	522156	–	522256	592256	522356	592356	522456	592456	522556	592556
100	522157	–	522257	–	522357	592357	522457	592457	522557	592557
120	522158	–	522258	592258	522358	592358	522458	592458	522558	592558
Min. Pkg.	50	–	50	50	50	50	50	50	50	50
Case Qty.	200	–	200	200	200	200	200	200	200	200
WITH VACUUM HOLES							4 HOLES		6 HOLES	
36	–	–	–	–	–	–	524452	594452	524552	594552
60	–	–	–	–	–	–	524455	594455	524555	594555
80	–	–	–	–	–	–	524456	594456	524556	594556
120	–	–	–	–	–	–	524458	594458	524558	–
Min. Pkg.							50	50	50	50
Case Qty.							200	200	200	200

4" and 5" sizes available. Also available in TP style attachment. Call for delivery and minimums.

QUICK CHANGE ALUMINUM OXIDE DISCS

Quick Change A/O Discs, 2 Ply

- Ideal for flat or contoured surfaces
- Best for MRO grinding, deburring & finishing on ferrous metals



QUICK CHANGE SILICON CARBIDE DISCS

Quick Change Silicon Carbide Discs, 2 Ply

- Sharp cutting points for rapid cutting action
- Used on non-ferrous metals

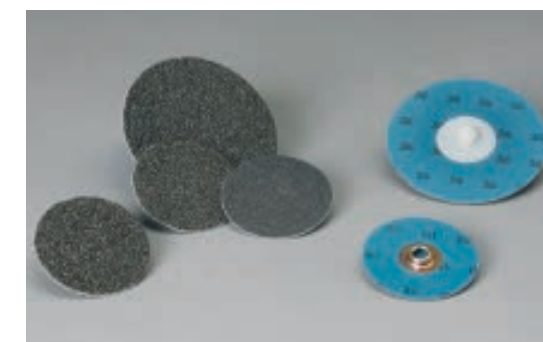

GRADE	3/4"		1"		1 1/2"		2"		3"		4"
	TS PART NO.	TR PART NO.	TS PART NO.	TR PART NO.	TS PART NO.	TR PART NO.	TS PART NO.	TR PART NO.	TS PART NO.	TR PART NO.	TS PART NO.
24	522101	–	522201	592201	522301	592301	522401	592401	522501	592501	522601
36	522102	–	522202	592202	522302	592302	522402	592402	522502	592502	522602
40	522103	–	522203	592203	522303	592303	522403	592403	522503	592503	522603
50	522104	–	522204	592204	522304	592304	522404	592404	522504	592504	–
60	522105	–	522205	592205	522305	592305	522405	592405	522505	592505	522605
80	522106	–	522206	592206	522306	592306	522406	592406	522506	592506	522606
100	522107	–	522207	592207	522307	592307	522407	592407	522507	592507	522607
120	522108	–	522208	592208	522308	592308	522408	592408	522508	592508	522608
150	522109	–	522209	–	522309	592309	522409	592409	522509	592509	–
180	522110	–	522210	592210	522310	592310	522410	592410	522510	592510	522610
240	522111	–	522211	592211	522311	592311	522411	592411	522511	592511	–
320	522112	–	522212	592212	522312	592312	522412	592412	522512	592512	–
Min. Pkg.	50	–	50	50	50	50	50	50	50	50	25
Case Qty.	200	–	200	200	200	200	200	200	200	200	250

See page 11 for holder pads. **Blue part numbers indicate in-stock products.**

4" and 5" sizes available. Also available in TP style attachment. Call for delivery and minimums.

GRADE	1"		1 1/2"		2"		3"	
	TS PART NO.	TR PART NO.	TS PART NO.	TR PART NO.	TS PART NO.	TR PART NO.	TS PART NO.	TR PART NO.
24	–	–	–	–	–	–	522513	–
36	522214	592214	522314	592314	522414	592414	522514	592514
40	522215	592215	522315	592315	522415	592415	522515	592515
50	–	592216	522316	592316	522416	592416	522516	592516
60	522217	592217	522317	592317	522417	592417	522517	592517
80	522218	592218	522318	592318	522418	592418	522518	592518
100	522219	592219	522319	592319	522419	592419	522519	592519
120	522220	592220	522320	592320	522420	592420	522520	592520
150	522221	592221	522321	592321	522421	592421	–	592521
180	522222	–	522322	592322	522422	592422	522522	592522
240	522223	592223	522323	592323	522423	592423	522523	592523
Min. Pkg.	50	50	50	50	50	50	50	50
Case Qty.	200	200	200	200	200	200	200	200

See page 11 for holder pads. **Blue part numbers indicate in-stock products.**

4" and 5" sizes available. Also available in TP style attachment. Call for delivery and minimums.

QUICK CHANGE ZIRCONIA PRO DISCS

Quick Change Zirconia Pro Discs, 2 Ply

- Better choice for rapid stock removal on Stainless Steel, High Nickel Alloys and Aluminum
- Features a grinding aid on a Y-weight backing
- Best performance under medium-to-heavy pressure



GRADE	1"		1 1/2"		2"		3"		
	TS PART NO.	TR PART NO.	TS PART NO.	TR PART NO.	TS PART NO.	TR PART NO.	TS PART NO.	TS PART NO.	TR PART NO.
36	528222	598222	528322	598322	528422	598422	528522	-	598522
40	528223	-	528323	598323	528423	598423	528523	-	598523
50	528224	598224	528324	598324	528424	598424	528524	-	598524
60	528225	598225	528325	598325	528425	598425	528525	-	598525
80	528226	598226	528326	598326	528426	598426	528526	-	598526
100	-	-	-	-	528427	-	-	528527	-
120	528228	598228	528328	598328	528428	598428	528528	-	598528
Min. Pkg.	50	50	50	50	50	50	50	50	50
Case Qty.	200	200	200	200	200	200	200	200	200

4" and 5" sizes available. Also available in TP style attachment. Call for delivery and minimums.

QUICK CHANGE CERAMIC OXIDE DISCS – continued

Quick Change Ceramic Pro Discs, 2 Ply

- Best choice for rapid stock removal on Stainless Steel, High Nickel Alloys and Aluminum
- Highest edge durability for prolonged edge work
- Great stock removal on flat surfaces
- Features a grinding aid for cooler operation

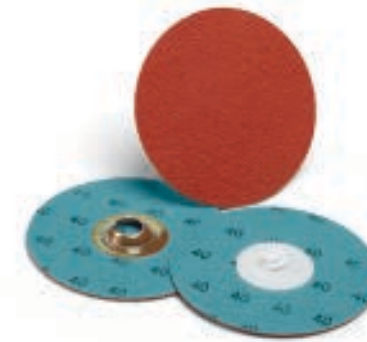

GRADE	1 1/2"		2"		3"		4"	
	TS PART NO.	TR PART NO.	TS PART NO.	TR PART NO.	TS PART NO.	TR PART NO.	TS PART NO.	TR PART NO.
40	527313	597313	527413	597413	527513	597513	527613	597613
60	527315	597315	527415	597415	527515	597515	527615	597615
80	527316	597316	527416	597416	527516	597516	527616	597616
120	527318	597318	527418	597418	527518	597518	527618	597618
Min. Pkg.	50	50	50	50	50	50	25	25
Case Qty.	200	200	200	200	200	200	100	100

5" sizes available. Also available in TP style attachment. Call for delivery and minimums.

Blue part numbers indicate in-stock products.

QUICK CHANGE CERAMIC OXIDE DISCS

Quick Change Ceramic Discs, 2 Ply

- Best choice for rapid stock removal on Stainless Steel and High Nickel Alloys
- Features a grinding aid for cooler operation
- Heavy pressure required



GRADE	1"		1 1/2"		2"		3"		
	TS PART NO.	TR PART NO.	TS PART NO.	TR PART NO.	TS PART NO.	TR PART NO.	TS PART NO.	TS PART NO.	TR PART NO.
36	525212	-	525312	595312	525412	595412	525512	-	595512
50	525214	-	525314	595314	525414	595414	525514	-	595514
60	525215	595215	525315	595315	525415	595415	525515	-	595515
80	525216	595216	525316	595316	525416	595416	525516	-	595516
100	525217	595217	525317	-	525417	595417	525517	-	595517
120	525218	595218	525318	595318	525418	595418	525518	-	595518
Min. Pkg.	50	50	50	50	50	50	50	50	50
Case Qty.	200	200	200	200	200	200	200	200	200

See page 11 for holder pads.

4" and 5" sizes available. Also available in TP style attachment. Call for delivery and minimums.

Blue part numbers indicate in-stock products.

QUICK CHANGE DISCS WITH 5/8-11 HUB

TS Attachment System with 5/8-11 Hub

- Incorporates a 5/8-11 metal TS hub for easy attachment to any pneumatic or electric right angle grinder with a 5/8-11 spindle

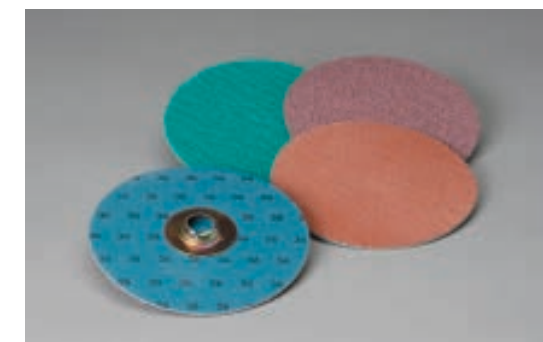

DIAMETER	GRADE	ATTACHMENT SYSTEM	ALUMINUM OXIDE	ZIRCONIA PRO	CERAMIC PRO
4 1/2"	36	TS	522802	528822	524881
	60	TS	522805	528825	524884
	80	TS	522806	528826	524885
5"	36	TS	522902	528922	524981
	60	TS	522905	528925	524984
	80	TS	522906	528926	524985
Max R.P.M.			10,000	10,000	10,000
Min. Pkg.			25	25	25
Case Qty.			100	100	100

See page 11 for holder pads.



Constructed using a quality Aluminum Oxide mineral.

- Good value general purpose disc for weld removal, grinding and blending
- Resin bond Aluminum Oxide provides durability and aggressive stock removal

GRADE	2"		3"	
	TS PART NO.	TR PART NO.	TS PART NO.	TR PART NO.
16	-	-	-	-
24	-	-	-	-
36	525402	595402	525502	595502
50	-	-	-	-
60	525405	595405	525505	595505
80	525406	595406	525506	595506
120	-	-	-	-
Min. Pkg.	100	100	50	50
Case Qty.	1000	1000	500	500

See page 11 for holder pads.
Blue part numbers indicate in-stock products.



An Alumina Zirconia disc constructed on a fiber backing. Provides a good option for both stainless and mild steel applications.

- Good value
- General purpose
- Versatile disc for use on a wide variety of metals

GRADE	2"		3"	
	TS PART NO.	TR PART NO.	TS PART NO.	TR PART NO.
36	525492	595492	525592	595592
50	525494	595494	525594	595594
60	525495	595495	525595	595595
80	525496	595496	525596	595596
Min. Pkg.	100	100	50	50
Case Qty.	1000	1000	500	500

- Firm face style has molded phenolic face for improved and snag-free grinding
- Easy-on/easy-off attachment systems
- Soft grade for fine finishing and contouring
- Medium grade for general purpose work
- Firm grade for heavy stock removal



ATTACHMENT SYSTEM	PAD ONLY PART NO.	PAD w/TA4 MANDREL PART NO.	DIAMETER	DENSITY	DESCRIPTION	MAXIMUM R.P.M.
TS	541001	541051	3/4"	Medium	SM 3/4	40,000
	541002	541052	1"	Medium	SM 1	40,000
	541003	541053	1 1/2"	Soft	SS 1 1/2	20,000
	541004	541054	1 1/2"	Medium	SM 1 1/2	25,000
	541005	541055	1 1/2"	Firm	SF 1 1/2	30,000
	541006	541056	2"	Soft	SS 2	20,000
	541007	541057	2"	Medium	SM 2	25,000
	541008	541058	2"	Firm	SF 2	30,000
	541009	541059	3"	Soft	SS 3	12,000
	541010	541060	3"	Medium	SM 3	20,000
	541011	541061	3"	Firm	SF 3	20,000
	541012	541062	4"	Medium	SM 4	12,000
TR	541014	541064	5"	Medium	SM 5	8,000
	546002	546052	1"	Medium	LM 1	20,000
	546003	546053	1 1/2"	Soft	LS 1 1/2	20,000
	546004	546054	1 1/2"	Medium	LM 1 1/2	25,000
	546005	546055	1 1/2"	Firm	LF 1 1/2	30,000
	546006	546056	2"	Soft	LS 2	20,000
	546007	546057	2"	Medium	LM 2	25,000
	546008	546058	2"	Firm	LF 2	30,000
	546009	546059	3"	Soft	LS 3	12,000
	546010	546060	3"	Medium	LM 3	20,000
TP	546011	546061	3"	Firm	LF 3	20,000
	-	548054	1 1/2"	Medium	PM 1 1/2	30,000
	-	548057	2"	Medium	PM 2	30,000
-	548060	3"	Medium	PM 3	20,000	

See page 5 for attachment system descriptions.

All TS and TR holder pads have 1/4"-20 female thread.
TP holder pads only available with TA4 Mandrel attached.
1/4" TA4 Mandrel available separately, part number 540013.

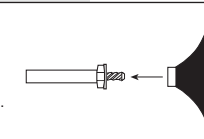

PAD MANDRELS		
PART NO.	DESCRIPTION	SIZE
540013	TA 4	1/4" Mandrel
440025	TA 6	6 MM Mandrel
541034	-	1/4" Mini Track Mandrel

Other adapters are available. Call for delivery and minimums.

TS Holder Pads for Discs with 5/8"-11 Hub



ATTACHMENT SYSTEM	PART NO.	DIAMETER	DENSITY	DESCRIPTION	MAXIMUM R.P.M.
TS	543630	4 1/2"	Medium	SM 45 F	13,300
	543632	5"	Medium	SM 55 F	12,000
BD*	543629	4 1/2"	Medium	BD 45 F	13,300
	543628	5"	Medium	BD 55 F	12,000

*BD - Low Profile Holder Pad designed to fit on most electric grinders.

Replacement retainer nut part number 542012.

Holder Pads have 5/8"-11 female thread.

Blue part numbers indicate in-stock products.

PAD ADAPTERS		
PART NO.	SIZE	
547003	5/8-11M x 3/8-24F	
547008	5/8-11M x 5/8-11F	
547024	5/8-11M x 1/2-13F	

Standard Abrasives™
Coated Abrasive
File Belts

Zirconia Belts

- Better choice for rapid stock removal on Stainless Steel, High Nickel Alloys and Aluminum
- Alumina Zirconia on a polyester weight cloth backing
- Resin bonded for heat resistance
- Features a grinding aid for cooler grinding
- Can be run wet or dry



	1/2" x 18"	1/2" x 24"	3/4" x 18"	3/4" x 20 1/2"
GRADE	PART NO.	PART NO.	PART NO.	PART NO.
36	580001	580002	580003	580004
60	580005	580006	580007	580008
80	580009	580010	580011	580012
120	580013	580014	580015	580016
Min. Pkg.	50	50	50	50
Case Qty.	50	50	50	50

Ceramic Belts

- Ceramic Aluminum Oxide blend abrasive grain on a polyester weight cloth backing
- Contains grinding aid which enhances performance on stainless steel and other exotic alloys
- Can be run wet or dry



	1/2" x 18"	1/2" x 24"	3/4" x 18"	3/4" x 20 1/2"	3 1/2" x 15 1/2"
GRADE	PART NO.	PART NO.	PART NO.	PART NO.	PART NO.
36	580017	580018	580019	580020	-
60	580021	580022	580023	580024	580038
80	580025	580026	580027	580028	580039
120	580029	580030	580031	580032	580040
Min. Pkg.	50	50	50	50	50
Case Qty.	50	50	50	50	50

Blue part numbers indicate in-stock products.

Standard Abrasives™
Resin Fiber Discs

Resin Fiber Discs are used for weld blending, grinding, deburring, and finishing applications on various metal substrates. Discs are ideal for removing imperfections on larger areas of all metals. They resist loading and have a high cut rate. Available in Aluminum Oxide, Premium Aluminum Oxide, Ceramic Oxide and Zirconia Alumina grains for a variety of applications.

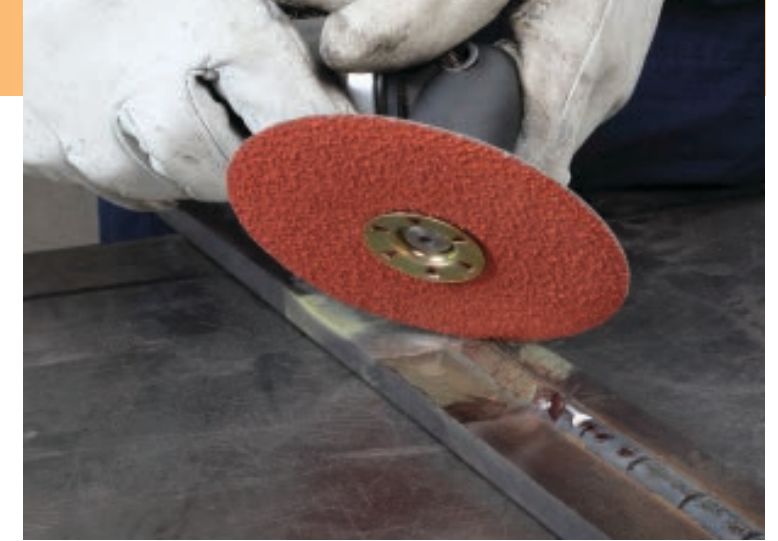

Aluminum Oxide Resin Fiber Discs

- Best disc for removing welds and imperfections along with blending and finishing larger surface areas on ferrous metals
- Closed-coat Aluminum Oxide resin bond has strong 30 mil fiber backing for durability
- Versatile attachment systems



Pictured: 7/8" Hole

GRADE	4 1/2"		5"		7"	
	TS PART NO.	with 7/8" HOLE PART NO.	TS PART NO.	with 7/8" HOLE PART NO.	TS PART NO.	with 7/8" HOLE PART NO.
16	531001	530001	531101	530101	531201	530201
24	531002	530002	531102	530102	531202	530202
36	531003	530003	531103	530103	531203	530203
50	531004	530004	531104	530104	531204	530204
60	531005	530005	531105	530105	531205	530205
80	531006	530006	531106	530106	531206	530206
120	531008	530008	531108	530108	531208	530208
Min. Pkg.	25	25	25	25	25	25
Case Qty.	100	100	100	100	100	100

For easy identification, the name and grit are imprinted on each disc.

The maximum allowable RPM for Resin Fiber Discs is the same as the maximum RPM of the holder pad used to drive the discs, provided the holder pad and the disc are the same nominal diameter.

Blue part numbers indicate in-stock products.

Zirconia Resin Fiber Discs

- Best disc for removing imperfections, gates, risers, and parting lines on ferrous, exotic metals such as super alloys, high-strength Stainless Steel, and Cobalt
- Premium Zirconia Alumina grain for durability and fast, aggressive cutting action

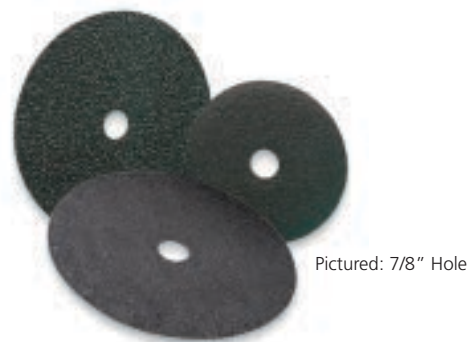

Pictured: 7/8" Hole

GRADE	4 1/2"		5"		7"	
	TS PART NO.	with 7/8" HOLE PART NO.	TS PART NO.	with 7/8" HOLE PART NO.	TS PART NO.	with 7/8" HOLE PART NO.
24	531091	530091	531191	530191	531291	530291
36	531092	530092	531192	530192	531292	530292
50	531093	530093	531193	530193	531293	530293
60	531094	530094	531194	530194	531294	530294
80	531095	530095	531195	530195	531295	530295
Min. Pkg.	25	25	25	25	25	25
Case Qty.	100	100	100	100	100	100

For easy identification, the name and grit are imprinted on each disc.

The maximum allowable RPM for Resin Fiber Discs is the same as the maximum RPM of the holder pad used to drive the discs, provided the holder pad and the disc are the same nominal diameter.

Ceramic Resin Fiber Discs

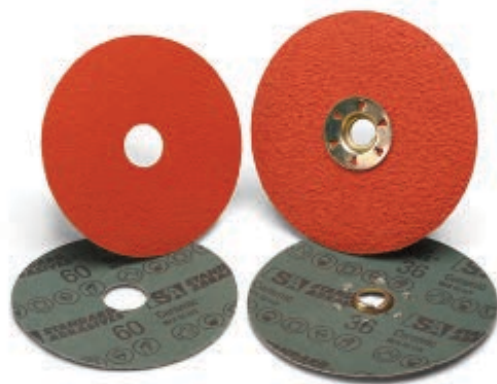

- Best disc for cool, rapid stock removal on all heat-sensitive metals, including Stainless Steel, Aluminum, High Nickel Alloys, Steel and Titanium
- Extremely durable ceramic grain; fastest stock removal of premium discs with easy grain regeneration
- Features a grinding aid that reduces heat, glazing, loading and stripping
- Heavy, durable fiber backing for superior grain support; ideal for prolonged stock removal
- Weld removal on fabricated Stainless Steel
- Heavy flash and parting line removal on castings

GRADE	4 1/2"		5"		7"	
	TS PART NO.	with 7/8" HOLE PART NO.	TS PART NO.	with 7/8" HOLE PART NO.	TS PART NO.	with 7/8" HOLE PART NO.
CERAMIC RESIN FIBER DISCS						
24	531032	530032	–	–	531321	530232
36	531033	530033	531312	530133	531322	530233
50	531035	530035	531314	530135	531324	530235
60	531036	530036	531315	530136	531325	530236
80	531037	530037	531316	530031	531326	530326
120	531039	530029	531318	530318	531328	530327

GRADE	4 1/2"		5"		7"	
	TS PART NO.	with 7/8" HOLE PART NO.	TS PART NO.	with 7/8" HOLE PART NO.	TS PART NO.	with 7/8" HOLE PART NO.
CERAMIC PRO RESIN FIBER DISCS						
24	–	530052	–	530152	–	530252
36	531053	530053	531153	530153	531253	530253
50	–	530055	–	530155	–	530255
80	–	530057	–	530157	–	530257
Min. Pkg.	25	25	25	25	25	25
Case Qty.	100	100	100	100	100	100

For easy identification, the name and grit are imprinted on each disc.

Blue part numbers indicate in-stock products.

Holder Pads for 4 1/2", 5" & 7" Discs



- Firm-face style has molded phenolic face for improved and snag-free grinding
- Easy-on/off metal-threaded center
- Soft grade for fine finishing and contouring
- Medium grade for general purpose work
- Firm grade for heavy stock removal

ATTACHMENT SYSTEM	PART NO.	DIAMETER	DENSITY	DESCRIPTION	MAXIMUM R.P.M.
TS	543630	4 1/2"	Medium	SM 45 F	13,300
	543632	5"	Medium	SM 55 F	12,000
	543602	7"	Soft	SS 7	8,600
	543603	7"	Medium	SM 7	8,600
	543604	7"	Firm	SF 7	8,600
BD*	543629	4 1/2"	Medium	BD 45 F	13,300
	543628	5"	Medium	BD 55 F	12,000

*BD – Low Profile Holder Pad designed to fit on most electric grinders.

Replacement retainer nut part number 542012. Holder Pads have 5/8"-11 female thread.

Blue part numbers indicate in-stock products.

PAD ADAPTERS		
	PART NO.	SIZE
	547003	5/8-11M x 3/8-24F
	547008	5/8-11M x 5/8-11F
	547024	5/8-11M x 1/2-13F

Holder Pads for 2" & 3" Discs

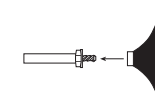

ATTACHMENT SYSTEM	PAD ONLY PART NO.	PAD w/TA4 MANDREL PART NO.	DIAMETER	DENSITY	PAD MANDRELS	
					PART NO.	DESCRIPTION
TS	541006	541056	2"	Soft	TA 4	1/4" Mandrel
	541007	541057	2"	Medium	TA 6	6 MM Mandrel
	541008	541058	2"	Firm		
	541009	541059	3"	Soft		
	541010	541060	3"	Medium		
	541011	541061	3"	Firm		
TR	546006	546056	2"	Soft	LS 2	20,000
	546007	546057	2"	Medium	LM 2	25,000
	546008	546058	2"	Firm	LF 2	30,000
	546009	546059	3"	Soft	LS 3	12,000
	546010	546060	3"	Medium	LM 3	20,000
	546011	546061	3"	Firm	LF 3	20,000

All TS and TR holder pads have 1/4"-20 female thread.

Standard Abrasives™ PSA Discs

Best disc for lighter duty blending, finishing and polishing on contoured surfaces of ferrous and non-ferrous materials. Made with Aluminum Oxide grain.

PSA Aluminum Oxide Discs

- Special pressure-sensitive adhesive leaves less adhesive residue
- Easy attachment/removal
- Flexible material is perfect for contoured applications



	1/2"	3/4"	1"	1 1/2"	2"	3"	4"	5"
GRADE	PART NO.	PART NO.	PART NO.	PART NO.	PART NO.	PART NO.	PART NO.	PART NO.
24	-	-	-	-	-	-	-	-
36	701648	701719	700916	701687	712974	711954	702484	701412 *
40	712330	712410	711580	712376	710598	709583	-	712123
50	706431	706503	705718	706475	704748	703717	-	706242
60	700548	700627	712909	700595	711880	710857	701351	700346
80	701868	701935	701122	701909	700153	712192	702701	701657
100	708331	709023	705215	705286	700209	712776	712248	707246
120	709607	710322	706487	706538	701476	700980	700472	708503
180	700431	701137	710336	710397	705360	704863	704341	712374
240	704306	705003	701149	701193	709160	708677	708186	703197
320	709407	710129	706294	706344	701263	700778	-	708297
400	-	-	-	-	-	-	-	722624
Min. Pkg.	100	100	100	100	100	100	50	50
Case Qty.	1000	1000	1000	1000	1000	1000	500	500

	6"	8"	9"	10"	12"	16"	20"	24"
GRADE	PART NO.	PART NO.	PART NO.	PART NO.	PART NO.	PART NO.	PART NO.	PART NO.
24	-	722173	-	-	703834	713157	700829	705847
36	704948	713907	713983	713377	709823	713255	706830	711833
40	702639	713067	714364	-	707505	713566	704474	709469
50	709739	713313	713225	713076	701616	713155	711613	703612
60	703857	713066	713088	713079	708751	713312	705752	710752
80	705169	713062	713059	713987	710056	713158	707045	712059
100	706739	713511	713152	714384	712597	-	712621	-
120	708027	713063	714855	714680	700811	715984	700841	723106
180	711853	714863	-	-	704680	-	719648	-
240	702743	716087	-	-	708512	-	722775	-
320	707820	-	-	-	700598	-	-	-
Min. Pkg.	50	10	10	10	10	10	10	10
Case Qty.	500	50	50	10	10	10	10	10

*5" PSA Disc, 36 Grit : Min. Pkg. 25; Case Qty. 250.

PSA Discs are available up to 40". Also available in Zirconia Pro. Call for delivery and minimums.

The maximum allowable RPM for PSA Discs is the same as the maximum RPM of the holder pad used to drive the discs, provided the holder pad and the disc are the same nominal diameter.

Blue part numbers indicate in-stock products.

PSA Zirconia Discs

- Increased cut rate over aluminum oxide

	5"	12"	20"
GRADE	PART NO.	PART NO.	PART NO.
36	727305	724921	724964
40	-	-	716943
60	714426	714873	723067
80	724738	727317	-
120	727047	-	727123
Min. Pkg.	50	-	-
Case Qty.	500	10	10

PSA Zirconia Pro Discs

- Better choice for rapid stock removal on stainless steel

	5"	6"	12"	20"
GRADE	PART NO.	PART NO.	PART NO.	PART NO.
40	-	724655	-	724875
50	730453	-	727025	724923
60	730454	730469	727180	-
80	-	730470	-	727133
120	-	730467	727026	-
Min. Pkg.	50	50	10	-
Case Qty.	500	500	10	10

PSA Discs are available up to 40". Call for delivery and minimums.

The maximum allowable RPM for PSA Discs is the same as the maximum RPM of the holder pad used to drive the discs, provided the holder pad and the disc are the same nominal diameter.

Holder Pads for PSA Discs

- Lightweight, flex-tested pad reduces operator fatigue and wear on air tools
- Fast, smooth handling at high-rated RPMs
- Perfect for contour applications



	1/2"	3/4"	1"	1 1/2"	2"	3"	4"	5"
SHANK DIA.	PART NO.	PART NO.	PART NO.	PART NO.	PART NO.	PART NO.	PART NO.	PART NO.
1/8"	720004	720005	720015	-	-	-	-	-
1/4"	719994	719993	719995	719996	719997	719998	719999	720000
Max. R.P.M.	18,000	18,000	15,000	15,000	12,000	10,000	7,000	5,000

Blue part numbers indicate in-stock products.

SIZE*	PART NO.	GRIT	SHAPE	CASE QTY.
3/8" x 1" x 1/8"	707096	60	Full Taper	1000
	708357	80	Full Taper	1000
	702229	120	Full Taper	1000
	706036	180	Full Taper	1000
3/8" x 1 1/2" x 1/8"	710094	50	Full Taper	1000
	704214	60	Full Taper	1000
	705509	80	Full Taper	1000
	706968	120	Full Taper	1000
3/8" x 2" x 1/8"	718217	120	Full Taper	1000
	710725	36	Full Taper	1000
1/2" x 1 1/2" x 1/8"	702565	50	Full Taper	1000
	709653	60	Full Taper	1000
	710928	80	Full Taper	1000
	712731	100	Full Taper	1000
	700939	120	Full Taper	1000
	704817	180	Full Taper	1000

SIZE*	PART NO.	GRIT	SHAPE	CASE QTY.
1/2" x 2" x 1/8"	700667	60	Full Taper	1000
	701974	80	Full Taper	1000
	702233	120	Full Taper	1000
3/4" x 1 1/2" x 3/16"	708572	50	Full Taper	500
	702768	60	Full Taper	500
	703989	80	Full Taper	500
3/4" x 1 1/2" x 1/8"	709291	60	Full Taper	500
	710580	80	Full Taper	500
3/4" x 2" x 3/16"	706105	60	Full Taper	250

*SIZE: Diameter x Length x Arbor Hole Diameter.
Additional straight, full tapered, half tapered and sidewall rolls are available. Call for delivery and minimums.

Blue part numbers indicate in-stock products.

Mandrels for Cartridge Roll

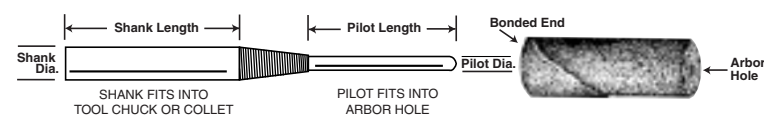

- Plated steel with a shank diameter to fit a variety of power tool chucks or collets
- Fits all Standard Abrasives™ Straight, Full Tapered, Half Tapered and Sidewall Cartridge Rolls

For safety considerations, Standard Abrasives recommends that the mandrel pilot length used to drive a cartridge roll should measure at least 1/2" less than the overall length of the cartridge roll. Example: If a cartridge roll measures 2" in overall length, the corresponding mandrel should have a pilot length of no less than 1 1/2".

PILOT DIAMETER	PART NO.	DESCRIPTION	PILOT LENGTH	SHANK DIAMETER	SHANK LENGTH	OVERALL LENGTH
3/32"	713638	CM-2B	3/4"	1/8"	1"	2 3/4"
	713287	CM-2C	1"	1/8"	1"	3"
	717078	CM-2E	3/4"	1/4"	1"	2 3/4"
	714740	CM-2F	1"	1/4"	1 1/4"	3"
1/8"	710893	CM-3	1/2"	1/8"	1"	2 1/2"
	700743	CM-4	3/4"	1/8"	1"	2 3/4"
	710213	CM-5	1"	1/8"	1"	3"
	708897	CM-6	1 1/2"	1/8"	1"	3 1/2"
	710870	CM-7	1/2"	1/4"	1 1/4"	2 1/4"
	700717	CM-8	3/4"	1/4"	1 1/4"	2 1/2"
	710190	CM-9	1"	1/4"	1 1/4"	2 3/4"
	708875	CM-10	1 1/2"	1/4"	1 1/4"	3 1/4"
	712230	CM-11	2"	1/4"	1 1/4"	4"
	716916	CM-XL	3/4"	1/4"	4 1/2"	6"
	717919	CM-XL	1"	1/4"	2 1/4"	4"
	716295	CM-XL	1"	1/4"	3 1/4"	5"
	716296	CM-XL	1"	1/4"	4 1/4"	6"
	717530	CM-XL	1"	1/4"	6 1/4"	8"
3/16"	704491	CM-15	3/4"	1/4"	1 1/4"	2 1/2"
	712689	CM-16	1"	1/4"	1 1/4"	3"
	702286	CM-17	1 1/2"	1/4"	1"	3 1/2"
	702296	CM-17	1 1/2"	1/4"	1 1/4"	3 3/8"
	701656	CM-18	2"	1/4"	1 1/4"	4"
1/4"	701111	CM-20	3/4"	1/4"	1 1/4"	2 3/4"
	712584	CM-21	1"	1/4"	1 1/4"	3"
	706874	CM-22	1 1/2"	1/4"	1 1/4"	3 1/2"
	701529	CM-23	2"	1/4"	1 1/4"	4"

Special sizes also available. Call for delivery and minimums.

Blue part numbers indicate in-stock products.

Standard Abrasives™ Precision Cartridge Rolls

Precision Cartridge Rolls (formerly Kay Rolls) run smoother and last longer than conventional Cartridge Rolls. The solid inner core bonds and supports the inner wrap of the roll, with self-trimming capability when in contact with the work piece. The secure bond of the total abrasive wrap to the drive stem eliminates loosening and vibration. Precision Cartridge Rolls are used when high tolerance and precision grinding is required.



- Fast cutting on irregular contours and hard-to-reach areas
- Flash removal, blending, deburring
- Edge breaking on all ferrous materials
- "C" model has an affixed stem that protrudes only about 5/8" into the core and used on larger tools
- "R" model has a rear mounted stem, making the entire roll usable, increasing productivity and reducing down time

Straight Model C

SIZE*	DESCR.	40 GRIT	60 GRIT	80 GRIT	100 GRIT	120 GRIT	180 GRIT
1/2" x 2 1/2" x 1/4"	C1	–	–	726016	726022	726026	726027
5/8" x 2 1/2" x 1/4"	C2	–	726070	726060	726051	726072	726037
1 3/16" x 2 1/2" x 1/4"	C3	726018	726012	726007	726021	726024	726028
1" x 2 1/2" x 1/4"	C4	726036	726000	726004	726005	726023	–

All rolls include 1/4" drive stem. Selected rolls are available with an extended 4" shaft. Call for delivery and minimums.

Straight Model R

SIZE*	DESCR.	40 GRIT	60 GRIT	80 GRIT	100 GRIT	120 GRIT	180 GRIT	320 GRIT
1/4" x 1 1/4" x 1/8"	R4	–	–	726020	726029	726034	726045	726019
3/8" x 1 3/4" x 1/4"	R6	–	726010	726003	726002	726015	726031	–
1/2" x 1 3/4" x 1/4"	R8	726032	726025	726006	726001	726011	726017	–

All rolls include 1/4" drive stem. Selected rolls are available with an extended 4" shaft. Call for delivery and minimums. Blue part numbers indicate in-stock products.

Full Tapered* Model R

SIZE*	DESCR.	60 GRIT	80 GRIT	100 GRIT	120 GRIT	180 GRIT	320 GRIT
3/8" x 1 3/4" x 1/4"	R6	726057	726059	–	726096	726050	726105
1/2" x 1 3/4" x 1/4"	R8	726049	726061	726098	726062	726101	–

*Model R also available in half taper. Please specify when ordering

Straight Zirconia Alumina

SIZE*	DESCR.	40 GRIT	60 GRIT	80 GRIT
3/8" x 1 3/4" x 1/4"	ZR6	–	726089	726065*
1/2" x 1 3/4" x 1/4"	ZR8	–	726106	726066*
1/2" x 2 1/2" x 1/4"	ZC1	–	–	726053
5/8" x 2 1/2" x 1/4"	ZC2	–	726091	–
1 3/16" x 2 1/2" x 1/4"	ZC3	726054	726055	–
1" x 2 1/2" x 1/4"	ZC4	–	726008	726009

*Also available in full or half tapered. All rolls include 1/4" drive stem. Selected rolls are available with an extended 4" shaft. Call for delivery and minimums.



Precision Cartridge Rolls Variety Sample Kit

PART NO. 726044

Contains an assortment of 7 popular Precision Cartridge Rolls, with different diameters, lengths and grits. Free for qualifying distributors.

Aluminum Oxide

- Deburring, cleaning, and polishing metal surfaces by hand
- Used on a turning part or on a split mandrel
- A necessity in machine and maintenance shops
- May be used with water, water-based, and oil-based coolants – eliminates costly degreasing of parts before polishing and deburring
- Maximum flexibility for extreme contour work
- Full resin bond material for wide range of applications and is longer lasting



SIZE	50J GRIT	60J GRIT	80J GRIT	100J GRIT	120J GRIT	150J GRIT	180J GRIT	220J GRIT	240J GRIT	320J GRIT	400J GRIT
1"	704821	711199	706221	704023	713095	715212	713199	713096	713200	713097	714696
1 1/2"	700379	706818	706311	712149	713159	713160	713161	713948	714179	713202	714164
2"	705762	712207	707195	708744	713297	713448	713276	713949	713205	713296	713648
Min. Pkg.	1	1	1	1	1	1	1	1	1	1	1
Case Qty.	10	10	10	10	10	10	10	10	10	10	10

Sizes not listed are considered Slit Rolls. Call for delivery and minimums.

SHEETS – 9" x 11"

- Deburring, cleaning and polishing metal surfaces by hand.
- Used as a small sheet of abrasive cloth.
- Flexibility for extreme contour work

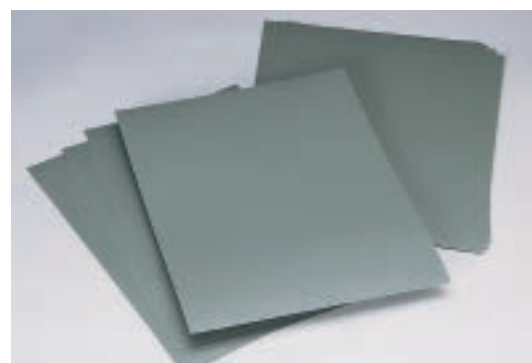

Cloth – A/O, Glue Bond, Metal Cloth

SIZE	80 GRIT	100 GRIT	120 GRIT	180 GRIT	240 GRIT	320 GRIT	400 GRIT
9" x 11"	713973	714094	713974	713976	714321	713975	713522
Weight	J	J	J	J	J	J	J
Min. Qty.	50	50	50	50	50	50	50

Paper – Silicon Carbide Waterproof

SIZE	80 GRIT	120 GRIT	180 GRIT	220 GRIT	240 GRIT	320 GRIT	400 GRIT	600 GRIT
9" x 11"	713314	715720	721508	713268	714504	713649	713626	713273
Weight	C	C	C	A	A	A	A	A
Min. Qty.	50	50	50	50	50	50	50	50

Blue part numbers indicate in-stock products.

Standard Abrasives™
Cut-Off Wheels

Standard Abrasives bonded Cut-Off Wheels are used for the toughest tasks including high-speed grinding on metals, precision cutting of metal parts and removing, cutting or otherwise changing the dimension of a work piece. Bonded construction provides durability, high performance and fast cutting.



- Sharp cutting edge produces precise and rapid cutting action
- Popular sizes for variety of off-hand applications
- Aluminum Oxide (A/O) material for simple jobs; use on a variety of materials including stainless steel, mild steel and aluminum
- High Performance Ceramic for tougher jobs; use on a variety of materials including stainless steel and aerospace alloys
- Abrasive grain throughout with fiber reinforcement from the O.D. to the I.D. result in fewer wheel changes and longer life

General Purpose A/O Cut-Off Wheels

PART NO.	SIZE	GRAIN	MAX. R.P.M.	MIN. PKG.	CASE QTY.
646220	3" x 1/32" x 3/8"	Aluminum Oxide	25,000	50	50
646240	3" x 1/16" x 3/8"	Aluminum Oxide	25,000	50	50
646320	4" x 1/32" x 3/8"	Aluminum Oxide	21,000	50	50
646340	4" x 1/16" x 3/8"	Aluminum Oxide	21,000	50	50
646570	6" x .045" x 7/8"	Aluminum Oxide	10,200	50	50

High Performance Ceramic Cut-Off Wheels

PART NO.	SIZE	GRAIN	MAX. R.P.M.	MIN. PKG.	CASE QTY.
646215	3" x 1/32" x 1/4"	Ceramic Oxide	35,000	50	50
646225	3" x 1/32" x 3/8"	Ceramic Oxide	35,000	50	50
646245	3" x 1/16" x 3/8"	Ceramic Oxide	28,000	50	50
646325	4" x 1/32" x 3/8"	Ceramic Oxide	26,250	50	50
646345	4" x 1/16" x 3/8"	Ceramic Oxide	21,000	50	50

Blue part numbers indicate in-stock products.

TS Quick Change with Vacuum Holes Discs

- For use on tools equipped with vacuum assist systems for the removal of dust and debris



SIZE	GRADE	GRAIN	HOLES	TS	TR	TP	REC. R.P.M.	MAX. R.P.M.	MIN. PKG.	CASE QTY.
2"	Coarse	A/O	4	840362	–	–	12,000	20,000	50	500
	Medium	A/O	4	840363	–	–	12,000	20,000	50	500
	Very Fine	A/O	4	840364	–	–	12,000	20,000	50	500
3"	Coarse	A/O	6	840462	–	–	10,000	18,000	25	250
	Medium	A/O	6	840463	–	–	10,000	18,000	25	250
	Very Fine	A/O	6	840464	–	–	10,000	18,000	25	250

HOLDER PADS FOR TS VACUUM HOLE DISCS	
PART NO.	FOR USE WITH
541054	TS Style 2" Vacuum Hole Discs
541360	TS Style 3" Vacuum Hole Discs

TS Quick Change P.A.R.T. Discs

- For use in the removal of surface contaminants, paint or primer at electrical grounding contact points



DIA.	HOLE	GRADE	GRAIN	DESCR.	TS	TR	TP	REC. R.P.M.	MAX. R.P.M.	MIN. PKG.	CASE QTY.
5/8"	3/32"	Medium	A/O	#30	800072	–	–	6,000	12,000	50	500
	1/8"	Medium	A/O	#21	800069	–	–	6,000	12,000	50	500
	5/32"	Medium	A/O	#10	800068	–	–	6,000	12,000	50	500

MANDRELS FOR P.A.R.T. DISCS						
PART NO.	DESCRIPTION	PIN DIA.	PIN LENGTH	SHANK DIA.	SHANK LENGTH	OVERALL LENGTH
541150	#10 Mandrel	3/16"	5/8"	1/4"	1 1/2"	3"
541151	#21 Mandrel	5/32"	5/8"	1/4"	1 1/2"	3"
541152	#30 Mandrel	1/8"	5/8"	1/4"	1 1/2"	3"
WITHOUT SHANK*						
541153	#10 Mandrel	3/16"	5/8"	–	–	–
541154	#21 Mandrel	5/32"	5/8"	–	–	–
541155	#30 Mandrel	1/8"	5/8"	–	–	–

REC. R.P.M. = Recommended R.P.M.

*Not stock items.

Blue part numbers indicate in-stock products.

Holder Pads for Quick Change Discs

- Firm face style has molded phenolic face for improved and snag-free grinding
- Easy-on/easy-off attachment systems
- Soft density for fine finishing and contouring
- Medium density for general purpose work
- Firm density for heavy stock removal



ATTACHMENT SYSTEM	PAD ONLY PART NO.	PAD w/TA4 MANDREL PART NO.	DIAMETER	DENSITY	DESCRIPTION	MAXIMUM R.P.M.
TS	541001	541051	3/4"	Medium	SM 3/4	40,000
	541002	541052	1"	Medium	SM 1	30,000
	541003	541053	1 1/2"	Soft	SS 1 1/2	20,000
	541004	541054	1 1/2"	Medium	SF 1 1/2	25,000
	541005	541055	1 1/2"	Firm	SF 1 1/2	30,000
	541006	541056	2"	Soft	SS 2	20,000
	541007	541057	2"	Medium	SM 2	25,000
	541008	541058	2"	Firm	SF 2	30,000
	541009	541059	3"	Soft	SS 3	12,000
	541010	541060	3"	Medium	SM 3	20,000
	541011	541061	3"	Firm	SF 3	20,000
	541012	541062	4"	Medium	SM 4	12,000
TR	541014	541064	5"	Medium	SM 5	8,000
	546002	546052	1"	Medium	LM 1	30,000
	546003	546053	1 1/2"	Soft	LS 1 1/2	20,000
	546004	546054	1 1/2"	Medium	LM 1 1/2	25,000
	546006	546056	2"	Soft	LS 2	20,000
	546007	546057	2"	Medium	LM 2	25,000
	546008	546058	2"	Firm	LF 2	30,000
	546009	546059	3"	Soft	LS 3	12,000
TP	546010	546060	3"	Medium	LM 3	20,000
	546011	546061	3"	Firm	LF 3	20,000
	–	548054	1 1/2"	Medium	PM 1 1/2	30,000
	–	548057	2"	Medium	PM 2	30,000
–	548060	3"	Medium	PM 3	20,000	

See page 5 for attachment system descriptions.

All TS and TR holder pads have 1/4"-20 female thread.

TP holder pads only available with TA4 Mandrel attached.

1/4" TA4 Mandrel available separately, part number 540013.

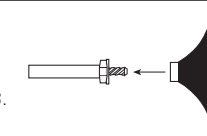

PAD MANDRELS		
PART NO.	DESCRIPTION	SIZE
540013	TA 4	1/4" Mandrel
440025	TA 6	6 MM Mandrel
541034	–	1/4" Mini Track Mandrel

Other adapters are available. Call for delivery and minimums.

TS Holder Pads Large Diameter

ATTACHMENT SYSTEM	PART NO.	DIAMETER	DENSITY	DESCRIPTION	MAXIMUM R.P.M.
TS	543630	4 1/2"	Medium	SM 45 F	18,000
	543632	5"	Medium	SM 55 F	18,000
	543602	7"	Soft	SS 7	8,600
	543603	7"	Medium	SM 7	8,600
	543604	7"	Firm	SF 7	8,600

Replacement retainer nut part number 542012.

Holder Pads have 5/8"-11 female thread.

Blue part numbers indicate in-stock products.

PAD ADAPTERS		
PART NO.	SIZE	
547003	5/8-11M x 3/8-24F	
547008	5/8-11M x 5/8-11F	
547024	5/8-11M x 1/2-13F	



Hook & Loop Style Discs

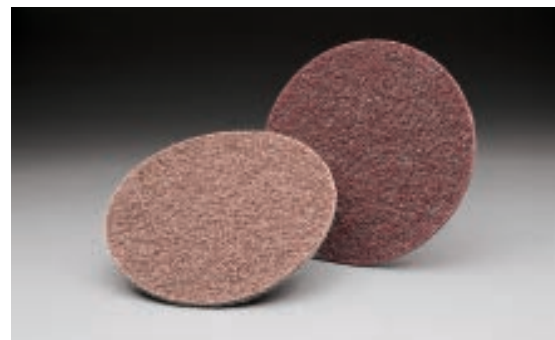

DIA.	GRADE	GRAIN	RC	FE	GP	REC. R.P.M.	MAX. R.P.M.	MIN. PKG.	CASE QTY.
2"	Coarse	A/O	842334	842331	842337	6,000	8,000	50	500
	Medium	A/O	842335	842332	842338	6,000	8,000	50	500
	Very Fine	A/O	842336	842333	842339	6,000	8,000	50	500
3"	Coarse	A/O	842434	842431	842437	6,000	8,000	25	250
	Medium	A/O	842435	842432	842438	6,000	8,000	25	250
	Very Fine	A/O	842436	842433	842439	6,000	8,000	25	250
4"	Coarse	A/O	845413	845411	845517	6,000	8,000	10	100
	Medium	A/O	845415	845412	845518	6,000	8,000	10	100
	Very Fine	A/O	845416	845414	845519	6,000	8,000	10	100
4 1/2"	Extra Coarse	A/O	845045	–	–	6,000	8,000	10	100
	Coarse	A/O	845513	845511	845417	6,000	8,000	10	100
	Medium	A/O	845515	845512	845418	6,000	8,000	10	100
	Very Fine	A/O	845516	845514	845419	6,000	8,000	10	100
5"	Extra Coarse	A/O	845050	–	–	5,000	7,000	10	100
	Coarse	A/O	845613	845611	845617	5,000	7,000	10	100
	Medium	A/O	845615	845612	845618	5,000	7,000	10	100
	Very Fine	A/O	845616	845614	845619	5,000	7,000	10	100
7"	Extra Coarse	A/O	845070	–	–	3,000	6,000	10	100
	Coarse	A/O	845813	845811	845817	3,000	6,000	10	100
	Medium	A/O	845815	845812	845818	3,000	6,000	10	100
	Very Fine	A/O	845816	845814	845819	3,000	6,000	10	100

Additional sizes are available for Surface Conditioning Discs. 4 1/2", 5" and 7" also available with 5/8" nominal hole. Call for delivery and minimums.
REC. R.P.M. = Recommended R.P.M.

Hook & Loop Style Holder Pads

SIZE	FOR PLAIN (VELCRO) STYLE DISCS	MAX. R.P.M.
2" x 1/4 Shank	840020	22,000
3" x 1/4 Shank	840030	18,000
4 1/2" with 5/8-11	840042	10,000
4" with 5/8-11	840040	10,000
5" with 5/8-11	840050	10,000
6" with 5/8-11	840060	10,000
7" with 5/8-11	840070	6,000

Blue part numbers indicate in-stock products.

Standard Abrasives™
Surface Conditioning Stars

Surface Conditioning Stars are designed for deburring, cleaning and polishing I.D. of pipe or tubing. The constant pressure applied to the walls of Steel, Aluminum, or plastics provides quick consistent finishes without dimensional changes. The Aluminum Oxide construction maximizes flexibility and edge durability.



SIZE	PART NO.	EYELET	GRADE	COLOR	MAX. R.P.M.	MIN. PKG.	CASE QTY.
2"	724605	1/4-20	Coarse	Brown	20,000	50	50
	724606	1/4-20	Medium	Maroon	20,000	50	50
	724607	1/4-20	Very Fine	Blue	20,000	50	50
3"	724602	1/4-20	Coarse	Brown	12,000	25	25
	724603	1/4-20	Medium	Maroon	12,000	25	25
	724604	1/4-20	Very	Blue	12,000	25	25

To be run in conjunction with TM-4 Mandrel.

Blue part numbers indicate in-stock products.

MANDREL				
PART NO.	DESCR.	SHANK LENGTH	THREAD DIA.	SIZE
707605	TM-4	3"	1/4"	1/4-20

**Standard Abrasives™
Bristle Discs**

4.5-inch Standard Abrasives Bristle Discs quickly and easily remove paint, stains, adhesives, weld burns, rust, heavy oxides and surface contaminant from large areas. Requires only light pressure, which helps reduce operator fatigue.

Fast running 2-inch and 3-inch discs with a standard TR attachment efficiently clean or strip many substances from metal surfaces, without damaging the work piece. An operator quickly and easily achieves a quality, consistent finish with light pressure.



- Remove a variety of surface contaminants
- Clean or strip many substances from metal surfaces
- Require only light pressure
- Does not damage work piece
- Fast-running
- Consistent finishes



3" BRISTLE DISCS WITH TR ATTACHMENT							
UPC NO. 051141-	SIZE	GRADE	COLOR	TRIM (T=TAPERED)	MAX. RPM	MIN. PKG.	CASE QTY.
43610-4	3"	50	Green	5/8" T	15,000	10	4
43611-1	3"	80	Yellow	5/8" T	15,000	10	4
43612-8	3"	120	White	5/8" T	15,000	10	4

4.5" BRISTLE DISCS							
UPC NO. 051141-	SIZE	GRADE	COLOR	MAX. RPM	MIN. PKG.	CASE QTY.	
43615-9	4 1/2" x 5/8-11	36	Brown	12,000	5	2	
43613-5	4 1/2" x 5/8-11	50	Green	12,000	5	2	
43614-2	4 1/2" x 5/8-11	80	Yellow	12,000	5	2	

**Standard Abrasives™
Buff & Blend Products**

Buff & Blend products are made from tough, resin-reinforced nylon fiber with abrasive grain. Each of the Standard Abrasives Buff & Blend materials offers unique benefits.

GP – Used for general duty applications, provides a high cut rate while producing consistent finishes.

HP – Stiff material produces an aggressive cut rate, designed for applications where metal removal is required.

HS REGULAR – High strength material has greater tear resistance, perfect for use on final finishing on irregular shaped parts.

HS COARSE – Best choice for tough applications that require a higher rate of cut or a coarser finish than HS Medium. It is ideal for satin and grain finishing applications, as well as blending and cleaning surface imperfections.

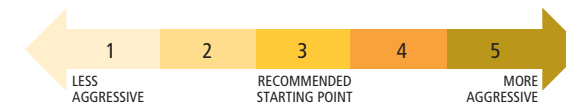

PRODUCT APPLICATIONS	BUFF & BLEND MATERIAL			
	GP	HP	HS REG	HS COARSE
BLEND: Blend minor surface imperfections, handling marks, coated abrasives secondary burrs	1 (GP VFINE) 4 (GP MED)		3 (HS MED)	5 (HS CRS)
CLEAN: Remove minor surface oxidation, coatings and rust; surface preparation prior to coating	1 (GP VFINE)		4 (HS MED)	5 (HS CRS)
DEBURR: Remove part lines from small castings, small burrs from threaded pipes, flash from plastic molded parts	1 (GP MED)	2 (HP VFINE)	3 (HS MED)	5 (HS CRS)
FINISH: Grain finishing on Stainless Steel after weld removal, cosmetic finishing on Aluminum castings			1 (HS VFINE) 4 (HS MED)	5 (HS CRS)
PRODUCT FEATURES				
Center hole discs may be ganged on a shaft and used as a wheel	•	•	•	•
Resists loading: No metal contamination to work piece	•	•	•	•
Extended duration of cut			•	
Eliminates edge fraying and grain shedding		•	•	•
Cool running	•	•	•	•
Long life		•	•	•
Reduced cost resulting from product durability and increased productivity		•	•	•
MATERIALS				
FERROUS	•	•	•	•
NON-FERROUS	•	•	•	•
ALUMINUM	•	•	•	•
HIGH NICKEL/CHROME ALLOYS	•	•	•	•
STAINLESS STEEL	•	•	•	•
PLATED PLASTICS				
BUILDERS HARDWARE			•	•
GRADES				
VERY FINE A/O	MAROON	RED	PINK	
FINE A/O	MAROON			
MEDIUM A/O	MAROON		BLUE	
COARSE A/O	MAROON			GREEN
VERY FINE S/C	GRAY			

- Flexible GP material conforms to contour, radius and I.D. areas
- Tough, resin-reinforced nylon fiber with abrasive grain provides a high rate of cut while producing consistent finishes
- Hook & Loop style available for random orbital sanding systems



GP Discs Quick Change Style

GRADE	GRAIN	COLOR	3/4"		1"		1 1/2"		2"			3"		4"		5"	
			TS PART NO.	TR PART NO.	TS PART NO.	TR PART NO.	TS PART NO.	TR PART NO.	TP PART NO.	TS PART NO.	TR PART NO.	TS PART NO.	TR PART NO.	TS PART NO.	TR PART NO.		
Coarse	A/O	Maroon	840011	840111	840211	810211	840311	-	-	-	840411*	-	-	-	-	-	-
Medium	A/O	Maroon	840012	840112	840212	810212	840312	810312	840317	840412	810412	840512	-	-	-	840612	-
Fine	A/O	Maroon	840013	840113	840213	810213	840313	810313	-	840413	810413	-	-	-	-	840613	-
Very Fine	A/O	Maroon	840015	840115	840215	810215	840315	810315	-	840415	810415	-	-	840515	-	-	-
Very Fine	S/C	Maroon	-	840121	-	-	840321	810321	-	840421*	-	-	-	-	-	-	-
Max. R.P.M.			12,000	12,000	12,000	12,000	12,000	12,000	12,000	8,000	8,000	10,000	10,000	10,000	10,000	10,000	10,000
Min. Pkg.			50	50	50	50	50	50	50	50	25	-	-	25	-	25	-
Case Qty.			500	500	500	500	500	500	500	500	250	25	25	25	25	25	25

Very Fine grade also available in Silicon Carbide. TP style discs also available. Call for delivery and minimums. *Min. Pkg. 25; Case Qty. 250.

GP Discs with Center Hole

GRADE	GRAIN	COLOR	5" x 1/2"	6" x 1/2"	7" x 1/2"	8" x 1/2"	10" x 1/2"	12" x 1 1/4"
Medium	A/O	Maroon	840610	840710	840810	840910	840110	849130
Fine	A/O	Maroon	840609	840709	840809	840909	840109	849129
Very Fine	A/O	Maroon	840608	840708	840808	840908	840108	849128
Max. R.P.M.			4,000	3,600	3,000	2,700	2,000	1,800
Min. Pkg.			10	10	10	10	10	5
Case Qty.			100	100	100	100	100	50

Very Fine grade also available in Silicon Carbide. Call for additional sizes, grades, delivery and minimums.

Discs can be ganged to form a wheel.

GP Discs with Hook & Loop

GRADE	GRAIN	COLOR	5" PLAIN	6" PLAIN	5" w/8 DUST HOLES	6" w/8 DUST HOLES
Medium	A/O	Maroon	831610	831710	831620	831720
Very Fine	A/O	Maroon	831608	831708	831618	831718
Max. R.P.M.			10,000	10,000	10,000	10,000
Min. Pkg.			10	10	10	10
Case Qty.			100	100	100	100

Very Fine grade also available in Silicon Carbide. Additional sizes are available. Call for delivery and minimums.

GP P.A.R.T. Discs, TS Style

DIA.	HOLE	GRADE	GRAIN	DESCR.	TS	TR	TP	REC. R.P.M.	MAX. R.P.M.	MIN. PKG.	CASE QTY.
5/8"	1/16"	Fine	A/O	#30	800075	-	-	6,000	12,000	50	500
	5/64"	Fine	A/O	#21	800067	-	-	6,000	12,000	50	500
	3/32"	Fine	A/O	#10	800066	-	-	6,000	12,000	50	500

MANDRELS FOR P.A.R.T. DISCS

PART NO.	DESCRIPTION	PIN DIA.	PIN LENGTH	SHANK DIA.	SHANK LENGTH	OVERALL LENGTH
541150	#10 Mandrel	3/16"	5/8"	1/4"	1 1/2"	3"
541151	#21 Mandrel	5/32"	5/8"	1/4"	1 1/2"	3"
541152	#30 Mandrel	1/8"	5/8"	1/4"	1 1/2"	3"
WITHOUT SHANK*						
541153	#10 Mandrel	3/16"	5/8"	-	-	-
541154	#21 Mandrel	5/32"	5/8"	-	-	-
541155	#30 Mandrel	1/8"	5/8"	-	-	-

Blue part numbers indicate in-stock products. REC. R.P.M. = Recommended R.P.M.

*Not stock item.

- High Strength is the best material for light deburring and finishing applications
- Very fine high luster and decorative finishes
- Final finishing on non-ferrous die cast molded parts
- Finishing on brass, steel, bronze, pewter, Stainless Steel, and plated plastics
- Polishing pipe threads and edges of molded glass containers
- High Strength Medium Type F Discs produce consistent satin finishes on Brass, Stainless Steel, Aluminum, Chrome and Nickel plated fixtures



HS Discs Quick Change Style

GRADE	GRAIN	COLOR	1"		2"		3"		4"		4 1/2"		5"	
			TS PART NO.	TR PART NO.	TS PART NO.	TR PART NO.	TS PART NO.	TR PART NO.	TS PART NO.	TR PART NO.	TS PART NO.	TR PART NO.		
Coarse	A/O	Green	-	840314	840319	840414	840419	861406	846821	846921	-	-	-	-
Medium	A/O	Blue	840157	840357	840358	840457	840458	811410	846822	846922	-	-	-	-
Very Fine	A/O	Maroon	-	840322	840323	-	-	-	-	-	-	-	-	
Max. R.P.M.			12,000	12,000	8,000	8,000	10,000	10,000	10,000	10,000	10,000	10,000	10,000	
Min. Pkg.			50	50	25	25	5	10	5	5	10	5	5	
Case Qty.			500	500	250	250	50	100	50	50	100	50	50	

HS Discs with Center Hole

GRADE	GRAIN	COLOR	5" x 1/2"	6" x 1/4"	6" x 1/2"	7" x 1/2"
Coarse	A/O	Green	-	-	860706	-
Medium	A/O	Blue	-	813710	810710	-
Very Fine	A/O	Maroon	860608	-	860708	860808
Max. R.P.M.			4,000	3,600	3,600	3,000
Min. Pkg.			10	10	10	10
Case Qty.			100	100	100	100

GRADE	GRAIN	COLOR	8" x 1/2"	8" x 3/4"	10" x 1/2"	10" x 3/4"
Coarse	A/O	Green	860906	-	-	-
Medium	A/O	Blue	810910	816910*	-	816110
Very Fine	A/O	Maroon	860908	866908	860108	-
Max. R.P.M.			2,700	2,700	2,000	2,000
Min. Pkg.			10	10	10	10
Case Qty.			100	100	100	10

GRADE	GRAIN	COLOR	10" x 7/8"	12" x 3/4"	12" x 1"	12" x 1 1/4"
Coarse	A/O	Green	-	-	-	869126
Medium	A/O	Blue	-	-	818130**	819130
Very Fine	A/O	Maroon	867108	866128	868128	869128
Max. R.P.M.			2,000	1,800	1,800	1,800
Min. Pkg.			10	5	5	5
Case Qty.			50	50	5	50

Additional sizes available. Call for delivery and minimums. *Min. Pkg. 5; Case Qty. 50. ** Min. Pkg. 5; Case Qty. 25.

Blue part numbers indicate in-stock products.

BUFF & BLEND HIGH STRENGTH (HS) DISCS

HS Medium Type F with Center Hole

PART NO.	SIZE	GRADE	GRAIN	COLOR	MAX. R.P.M.	MIN. PKG.	CASE QTY.
860710	6" x 1/2"	Medium	A/O	Blue	3,600	5	50
860910	8" x 1/2"	Medium	A/O	Blue	2,700	5	50
865110	10" x 5/8"	Medium	A/O	Blue	2,000	–	5
869130	12" x 1 1/4"	Medium	A/O	Blue	1,800	5	50

HS Type 27 Discs

PART NO.	SIZE	GRADE	GRAIN	COLOR	MAX. R.P.M.	MIN. PKG.	CASE QTY.
811030	4 1/2" x 7/8"	Coarse	A/O	Green	8,000	5	50
811031	4 1/2" x 7/8"	Medium	A/O	Blue	8,000	5	50

BUFF & BLEND HP DISCS

- HP material's durable construction is aggressive and withstands heavy edge work while deburring
- Edge deburring on Aluminum extrusions
- Deburring Aluminum die cast flashing
- Removing heavy surface oxidation



HP Discs Quick Change Style

GRADE	GRAIN	COLOR	2"		3"	
			TS PART NO.	TR PART NO.	TS PART NO.	TR PART NO.
Very Fine	A/O	Red	850315	850325	850415	850425
Max. R.P.M.			12,000	12,000	8,000	8,000
Min. Pkg.			50	50	25	25
Case Qty.			500	500	250	250

HP Discs with Center Hole

GRADE	GRAIN	COLOR	5" x 1/2"	6" x 1/2"	7" x 1/2"	8" x 1/2"	10" x 1/2"	12" x 1/4"
			PART NO.	PART NO.	PART NO.	PART NO.	PART NO.	PART NO.
Very Fine	A/O	Red	850608	850708	850808	850908	850108	859128
Max. R.P.M.			4,000	3,600	3,000	2,700	2,000	1,800
Min. Pkg.			10	10	10	10	10	5
Case Qty.			100	100	100	100	100	50

Blue part numbers indicate in-stock products.

BUFF & BLEND AP DISCS

- AP is tough cutting and aggressive for medium duty cleaning, yet soft and pliable to conform to irregular surfaces



GRADE	GRAIN	COLOR	6" x 1/4"	6" x 1/2"	8" x 1/2"	8" x 3/4"	8" x 1 1/4"	12" x 1 1/4"
			PART NO.	PART NO.	PART NO.	PART NO.	PART NO.	PART NO.
Medium	A/O	Tan	873710	870710	870910	876910	–	879130
Very Fine	A/O	Red	853708	–	–	–	859908	–
Max. R.P.M.			3,600	3,600	2,700	2,700	2,700	1,800
Min. Pkg.			10	10	10	–	10	5
Case Qty.			100	100	100	10	100	50

Additional sizes and grades available. Call for delivery and minimums.

Blue part numbers indicate in-stock products.

Holder Pads for Quick Change Discs

- Hard-face style has molded phenolic face for improved and snag-free grinding
- Cool running
- Easy-on/easy-off attachment systems
- Soft grade for fine finishing and contouring; Medium grade for general purpose work; Firm grade for heavy stock removal



ATTACHMENT SYSTEM	PAD ONLY PART NO.	PAD w/TA4 MANDREL PART NO.	DIAMETER	DENSITY	DESCRIPTION	MAXIMUM R.P.M.
TS	541001	541051	3/4"	Medium	SM 3/4	40,000
	541002	541052	1"	Medium	SM 1	40,000
	541003	541053	1 1/2"	Soft	SS 1 1/2	20,000
	541004	541054	1 1/2"	Medium	SM 1 1/2	25,000
	541005	541055	1 1/2"	Firm	SF 1 1/2	30,000
	541006	541056	2"	Soft	SS 2	20,000
	541007	541057	2"	Medium	SM 2	25,000
	541008	541058	2"	Firm	SF 2	30,000
	541009	541059	3"	Soft	SS 3	12,000
	541010	541060	3"	Medium	SM 3	20,000
	541011	541061	3"	Firm	SF 3	20,000
	541012	541062	4"	Medium	SM 4	12,000
541014	541064	5"	Medium	SM 5	8,000	
TR	546002	546052	1"	Medium	LM 1	20,000
	546003	546053	1 1/2"	Soft	LS 1 1/2	20,000
	546004	546054	1 1/2"	Medium	LM 1 1/2	25,000
	546005	546055	1 1/2"	Firm	LF 1 1/2	30,000
	546006	546056	2"	Soft	LS 2	20,000
	546007	546057	2"	Medium	LM 2	25,000
	546008	546058	2"	Firm	LF 2	30,000
	546009	546059	3"	Soft	LS 3	12,000
546010	546060	3"	Medium	LM 3	20,000	
546011	546061	3"	Firm	LF 3	20,000	
TP	-	548054	1 1/2"	Medium	PM 1 1/2	30,000
	-	548057	2"	Medium	PM 2	30,000
	-	548060	3"	Medium	PM 3	20,000

See page 5 for attachment system descriptions.

All TS and TR holder pads have 1/4"-20 female thread.
TP holder pads only available with TA4 Mandrel attached.
1/4" TA4 Mandrel available separately, part number 540013.

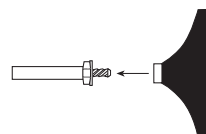

PAD MANDRELS		
PART NO.	DESCRIPTION	SIZE
540013	TA 4	1/4" Mandrel
440025	TA 6	6 MM Mandrel
541034	-	1/4" Mini Track Mandrel

Other adapters are available. Call for delivery and minimums.

TS Holder Pads Large Diameter

ATTACHMENT SYSTEM	PART NO.	DIAMETER	DENSITY	DESCRIPTION	MAXIMUM R.P.M.
TS	543630	4 1/2"	Medium	SM 45 F	18,000
	543632	5"	Medium	SM 55 F	18,000

Replacement retainer nut part number 542012.

Holder Pads have 5/8"-11 female thread.

PAD ADAPTERS		
PART NO.	DESCRIPTION	SIZE
547003		5/8-11M x 3/8-24F
547008		5/8-11M x 5/8-11F
547024		5/8-11M x 1/2-13F

Hook & Loop Style Holder Pads for GP Discs

SIZE	FOR HOOK & LOOP SYSTEM PLAIN PAD WITH 5/16-24M THREAD VELOUR	FOR HOOK & LOOP SYSTEM DUST HOLES WITH 5/16-24M THREAD VELOUR	MAX. R.P.M.
5"	840052	840053	10,000
6"	840062	-	10,000

Blue part numbers indicate in-stock products.

GP Wheels

- Permanently affixed 1/4" shank eliminates "ganging" of individual discs
- Waterproof; may be used with lubricants
- Choice of 1, 2, or 3-ply for best utilization
- For use on small, straight grinders
- Fast removal of rust, oxidation and scale
- Cleaning, polishing, and high luster finishing



GRADE	GRAIN	2"			3"				4"			
		1-PLY PART NO.	2-PLY PART NO.	3-PLY PART NO.	1-PLY PART NO.	2-PLY PART NO.	3-PLY PART NO.	4-PLY PART NO.	1-PLY PART NO.	2-PLY PART NO.	3-PLY PART NO.	4-PLY PART NO.
Medium	A/O	880213	880215	880216	880413	880415	880416	880417	880613	880615	880616	880617
Very Fine	A/O	880313	880315	880316	880513	880515	880516	-	880713	880715	880716	-
Max. R.P.M.		12,000	12,000	12,000	8,000	8,000	8,000	8,000	6,000	6,000	6,000	6,000
Min. Pkg.		10	10	10	10	10	10	5	5	5	5	5
Case Qty.		100	100	100	100	100	100	50	5	5	5	5

3" and 5" wheels are also available in 4 and 5-ply. Call for delivery and minimums.

GRADE	GRAIN	5"		
		1-PLY PART NO.	2-PLY PART NO.	3-PLY PART NO.
Medium	A/O	880813	880815	880816
Very Fine	A/O	880913	880915	880916
Max. R.P.M.		4,000	4,000	4,000
Min. Pkg.		5	5	5
Case Qty.		5	5	5

HS Medium Wheels

PART NO.	SIZE	PLY	GRADE	GRAIN	MAX. R.P.M.	MIN. PKG.	CASE QTY.
880475	3"	2	Medium	A/O	8,000	10	100
880476	3"	3	Medium	A/O	8,000	10	100

Blue part numbers indicate in-stock products.

GP Circle Buffs

- Plies are held together with a threaded eyelet
- 2" have 8-32 eyelet; 3" through 5" have 1/4"-20 eyelet



GRADE	GRAIN	2"			3"			4"			5"		
		1-PLY PART NO.	2-PLY PART NO.	3-PLY PART NO.	1-PLY PART NO.	2-PLY PART NO.	3-PLY PART NO.	1-PLY PART NO.	2-PLY PART NO.	3-PLY PART NO.	1-PLY PART NO.	2-PLY PART NO.	3-PLY PART NO.
Medium	A/O	724274	724276	724278	724280	724282	724284	724286	-	724290	-	-	724296
Very Fine	A/O	724275	724277	724279	724281	-	724285	-	724289	724291	-	-	724297
Eyelet		8-32	8-32	8-32	1/4-20	1/4-20	1/4-20	1/4-20	1/4-20	1/4-20	1/4-20	1/4-20	1/4-20
Max. R.P.M.		12,000	12,000	12,000	8,000	8,000	8,000	6,000	6,000	6,000	4,000	4,000	4,000
Min. Pkg.		25	25	25	25	25	25	25	25	25	25	25	25
Case Qty.		250	250	250	-	-	-	-	-	-	-	-	-

Due to manufacturing variations inherent to non-woven nylon abrasives, the total thickness of the wheels may vary. 1 ply of Very Fine is approximately .40" thick. 1 ply of Medium is approximately .33" thick.

MANDRELS FOR CIRCLE BUFFS					
PART NO.	DESCR.	O.A. LENGTH	SHANK DIA.	THREAD SIZE	
703946	TM-2	2 1/2"	1/4"	3-48	
700143	TM-3	3"	1/4"	8-32	
707605	TM-4	3"	1/4"	1/4-20	

Buff & Blend Combi-Wheels

Standard Abrasives™
Buff & Blend Combi-Wheels

Designed with alternating flaps of Buff & Blend GP and coated abrasive A/O resin bond materials, Combi-Wheels provide blending action while leaving a consistent and final finish on the work piece. They are durable and resist smearing. Used on small straight pneumatic and electric grinders, the permanently affixed 1/4" shank provides smooth running and ease of control for "off hand" operations.

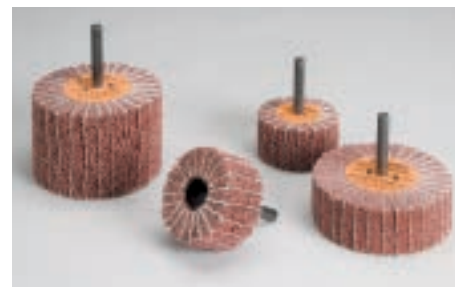

- Removes heavy oxidation prior to painting and/or plating
- Deburr and grain finishing Stainless Steel sheets after coated abrasives
- Finishes stamped or extruded Aluminum parts
- Satin finishing large surfaces
- Blending, cleaning, and finishing on ferrous and non-ferrous materials when a linear scratch pattern is required and final finish is a primary concern

LESS AGGRESSIVE ← → MORE AGGRESSIVE

Flap Brushes Combi-Wheels Flap Wheels

GRIT	GRAIN	GRADE	2" x 1" x 1/4"	3" x 1" x 1/4"	3" x 2" x 1/4"
60	A/O	Medium	898000	898004	898008
80	A/O	Medium	898001	898005	898009
80	S/C	Very Fine	—	—	898015
120	A/O	Very Fine	898002	898006	898010
180	A/O	Very Fine	898003	898007	898011
Max. R.P.M.			15,000	12,000	12,000
Min. Pkg.			10	10	5
Case Qty.			100	100	50

BUFF & BLEND FLAP BRUSHES

Mounted Flap Brushes

Standard Abrasives™
Buff & Blend Mounted Flap Brushes

Mandrel Mounted Flap Brushes are soft and conformable. The Buff & Blend GP material allows removing surface contaminants without eliminating critical detail or gouging the work piece. Its design utilizes the "face" of the material rather than the "edge," resulting in fine finishes without leaving "lines" associated with ganged arbor hole discs. They are waterproof and may be used with lubricants.



- Decorative satin and matte finishing on Stainless Steel, Brass and Aluminum
- In-line brush finish for Stainless Steel and Aluminum cookware; high luster finishes
- Removes surface contaminants such as rust, grease and oils
- Finishing Aluminum extrusions
- Load-resistant; no metal contamination of work piece

GRADE	GRAIN	2" x 2" x 1/4"		3" x 2" x 1/4"	
		GP PART NO.	AP PART NO.	GP PART NO.	AP PART NO.
Medium	A/O	875500	875510	875501	875511
Color		Maroon	Tan	Maroon	Tan
Max. R.P.M.		15,000	15,000	12,000	12,000
Min. Pkg.		10	10	5	5
Case Qty.		100	100	50	50

Blue part numbers indicate in-stock products.

Mini Brushes

Standard Abrasives™
Mini Brushes

Standard Abrasives Mini-Brushes are the fast, easy way to restore finishes to their original condition.

- Delivers high-quality finish
- Long-lasting
- Easy to control
- Conforms to most surface geometries
- Saves time and labor costs
- Uses a simple repeatable procedure that any operator can quickly master



	SIZE	GRADE	PART NO.	MAX. R.P.M.	CASE QTY.
HIGH STRENGTH MINI-BRUSH	4 1/2" x 2" x 5/8-11	A/O Medium	875710	3,500	1
		A/O Coarse	875709	3,500	1
MINI-BRUSH	4 1/2" x 4" x 5/8-11	A/O Medium	875701	3,500	2
		A/O Coarse	875700	3,500	2
		A/O Very Fine	875704	3,500	1
		A/O Medium	875703	3,500	1
	4 1/2" x 2" x 5/8-11	A/O Extra Coarse	875702	3,500	1
		S/C Medium	875705	3,500	1
		A/O Very Fine	875713	3,500	1
		A/O Medium	875712	3,500	1
MINI-BRUSH INTERLEAF	4 1/2" x 2" x 5/8-11	A/O Extra Coarse	875711	3,500	1
		S/C Medium	875714	3,500	1
		A/O 60	875715	3,500	2
	4 1/2" x 4" x 5/8-11	A/O 100	875716	3,500	2
		A/O 150	875717	3,500	2
		A/O 60	875706	3,500	1
	A/O 100	875707	3,500	1	
	A/O 150	875708	3,500	1	

HS Buff & Blend Flap Brushes are also available in coarse grade in hard and medium densities. Choose from 6", 8", 12" and 14" diameters. Additional sizes are available. Call for delivery and minimums.

Blue part numbers indicate in-stock products.

Buff & Blend Flap Brushes

Standard Abrasives™
Buff & Blend Flap Brushes

Conformable flap brushes allow for controlled wheel action, maximizing removal of surface contaminants without removing critical detail or gouging the work piece. They produce a consistent finish which does not reflect lines commonly attributed with ganged arbor hole discs. Density, pressure and angle determine the ability of the Flap Brush to remove burrs, oxidation and handling marks. The abrasive material provides ventilation which helps dissipate heat and, therefore, runs cooler. This provides consistent finishes without smearing or otherwise discoloring the work piece. Minimal vibration can reduce chattermarks on the work piece and can lead to less operator and machine fatigue. Use on the following tools: Straight Shaft Portable Grinder, Bench Motor, Backstand, Floor Lathe, Rotary, Straight Line, and Robotic.



- Uniform and long line brushes finishes on Aluminum, Brass and Stainless Steel
- Grain finish on brass strike plates for door hardware
- Satin finish on builders' hardware (cabinet handles, door knobs, and more)
- Satin finishes on soft metals
- Highlighting and finishing Aluminum extrusions (used as a quality control tool to identify defects)
- Inline brushed finish on Aluminum and Stainless cookware (pots and pans)
- Produce fine scratch pattern on utensils and cutlery prior to cotton buff and compound polishing
- Remove oxide from precious metals
- Blending flash and parting lines on Aluminum die cast

DENSITY	GRADE	COLOR	6" x 1" x 2"	6" x 2" x 2"	8" x 1" x 3"	8" x 1 1/2" x 3"
			PART NO.	PART NO.	PART NO.	PART NO.
Medium	Very Fine	Maroon	875000	–	875002	–
	Medium	Maroon	875001	875076	875003	–
	HS Medium	Blue	875143	–	875176	–
Hard	Very Fine	Maroon	875008	–	875010	875065
	Medium	Maroon	875009	875028	875011	875224
	HS Very Fine	Maroon	–	–	–	875121
	HS Medium	Blue	875139	–	–	–
Max. R.P.M.			3,400	3,400	3,200	3,200
Min. Pkg.			1	1	1	1
Case Qty.			3	2	3	2

DENSITY	GRADE	COLOR	8" x 2" x 3"	12" x 1" x 5"	12" x 1 1/2" x 5"	12" x 2" x 5"
			PART NO.	PART NO.	PART NO.	PART NO.
Medium	Very Fine	Maroon	875074	875004	–	875006
	Medium	Maroon	875021	875005	–	875007
	HS Medium	Blue	875175	875144	875221	875145
Hard	Very Fine	Maroon	–	875012	875352*	875014
	Medium	Maroon	875023	875013	875342	875015
	HS Very Fine	Maroon	–	–	–	875181
	HS Medium	Blue	–	875205	875285	875140
	HS Coarse	Green	–	–	875277	–
Max. R.P.M.			3,200	2,500	2,500	2,500
Min. Pkg.			1	1	1	1
Case Qty.			2	4	3	25

HS Buff & Blend Flap Brushes are also available in coarse grade in hard and medium densities. Choose from 6", 8", 12" and 14" diameters. Additional sizes are available. Call for delivery and minimums. *2 per case. **Blue part numbers indicate in-stock products.**

Flange Adapters for Flap Brushes

PART NO.	USE WITH	MIN. PKG.
850071	6" diameter Flap Brush with 2" center hole	1
850077	8" diameter Flap Brush with 3" center hole	1
850087	12" diameter Flap Brush with 5" center hole	1
850081	14" diameter Flap Brush with 8" center hole	1

These flange adapters are made to order and machined for extra durability. To ensure size accuracy of flanges, when ordering, please specify Flap Brush outside diameter dimension and flange arbor hole size.



SPECIAL ORDER NOTICE: Call for standard hole sizes. Non-standard hole sizes available as Made-To-Order items; call for additional pricing, minimums and delivery.

Standard Abrasives™
Buff & Blend Cross Buffs

Cross Buffs are ideal for polishing and cleaning inside diameters and hard-to-reach areas on metal surfaces. Its unique design conforms to I.D.s. Perfect for automotive and other applications including:

Cleaning: Removing surface oxidation, rust and surface coatings for part inspection; surface preparation prior to coating; removing corrosion on Steel Rule and Kirksite dies.

Polishing: Polishing round and square tubing, valve spools, molds, dies and inside diameters of lifter bores, valve bodies and brake cylinders.



- Durable construction withstands heavy edge work while blending and polishing; long life
- Extended duration and rate of cut
- Cool running
- Satin finishes on soft metals
- Eliminates changing critical tolerances
- Quick change

Cross Buffs

PART NO.	SIZE x WIDTH	PLY	EYELET	GRADE	COLOR	GRAIN	MAX. R.P.M.	MIN. PKG.	CASE QTY.
725017	3/4" x 3/8"	2	8-32	GP Fine	Maroon	A/O	20,000	50	500
725019		2	8-32	HS Medium	Blue	A/O	20,000	50	500
725011		2	8-32	HP Very Fine	Maroon	A/O	20,000	50	500
724904	1" x 3/8"	2	8-32	GP Very Fine	Gray	S/C	20,000	50	500
727334		2	8-32	HS Coarse	Green	A/O	20,000	50	500
725007		2	8-32	HS Medium	Blue	A/O	20,000	50	500
725008		2	8-32	HP Very Fine	Maroon	A/O	20,000	50	500
727460	1 1/4" x 1/2"	3	8-32	HS Medium	Blue	A/O	20,000	50	500
727459		3	8-32	HP Very Fine	Maroon	A/O	20,000	50	500
725000	1 1/2" x 1/2"	2	8-32	GP Very Fine	Gray	S/C	20,000	50	500
725002		2	8-32	GP Very Fine	Gray	A/O	20,000	50	500
725014		2	8-32	GP Medium	Maroon	A/O	20,000	50	500
725004		2	8-32	GP Coarse	Brown	A/O	20,000	50	500
727394		2	8-32	HS Coarse	Green	A/O	20,000	50	500
725012		2	8-32	HS Medium	Blue	A/O	20,000	50	500
725013		2	8-32	HP Very Fine	Maroon	A/O	20,000	50	500
725001		3	8-32	GP Medium	Maroon	A/O	20,000	50	500
727333		3	8-32	HS Coarse	Green	A/O	20,000	50	500
725005		3	8-32	HS Medium	Blue	A/O	20,000	50	500
725006		3	8-32	HP Very Fine	Maroon	A/O	20,000	50	500
727466		2" x 1/2"	2	8-32	GP Very Fine	Gray	S/C	20,000	25
727395	2		8-32	HS Coarse	Green	A/O	12,000	50	500
727396	2		8-32	HS Medium	Blue	A/O	12,000	50	500
727397	2		8-32	HP Very Fine	Red	A/O	12,000	50	500
727398	2" x 3/4"	2	1/4-20	HS Coarse	Green	A/O	12,000	50	500
727399		2	1/4-20	HS Medium	Blue	A/O	12,000	50	500
727400		2	1/4-20	HP Very Fine	Red	A/O	12,000	50	500
727401	3" x 3/4"	2	1/4-20	HS Coarse	Green	A/O	8,000	50	500
727402		2	1/4-20	HS Medium	Blue	A/O	8,000	50	500
727403		2	1/4-20	HP Very Fine	Red	A/O	8,000	50	500

Blue part numbers indicate in-stock products.

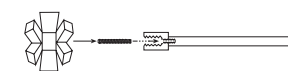

MANDRELS FOR CROSS BUFFS & COMBI CROSS BUFFS			
PART NO.	SIZE	SHANK DIA.	THREAD SIZE
869201*	4"	1/4"	1/4-20 F
700143	3"	1/4"	8-32
707605	3"	1/4"	1/4-20

*Includes 8-32 M Adapter.

Quick Change Cross Buffs

PART NO.	SIZE x WIDTH	PLY	EYELET	GRADE	COLOR	GRAIN	MAX. R.P.M.	MIN. PKG.	CASE QTY.
725019	3/4" x 3/8"	2	8-32	HS Medium	Blue	A/O	20,000	50	500
725011		2	8-32	HP Very Fine	Maroon	A/O	20,000	50	500
727334	1" x 3/8"	2	8-32	HS Coarse	Green	A/O	20,000	50	500
725007		2	8-32	HS Medium	Blue	A/O	20,000	50	500
725008		2	8-32	HP Very Fine	Maroon	A/O	20,000	50	500
725000	1 1/2" x 1/2"	2	8-32	GP Very Fine	Gray	S/C	20,000	50	500
725004		2	8-32	GP Coarse	Brown	A/O	20,000	50	500
725012		2	8-32	HS Medium	Blue	A/O	20,000	50	500
725013		2	8-32	HP Very Fine	Maroon	A/O	20,000	50	500
727333		3	8-32	HS Coarse	Green	A/O	20,000	50	500
725005		3	8-32	HS Medium	Blue	A/O	20,000	50	500
725006	3	8-32	HP Very Fine	Maroon	A/O	20,000	50	500	
727395	2" x 1/2"	2	8-32	HS Coarse	Green	A/O	12,000	50	500
727396		2	8-32	HS Medium	Blue	A/O	12,000	50	500
727397		2	8-32	HP Very Fine	Red	A/O	12,000	50	500
727398	2" x 3/4"	2	1/4-20	HS Coarse	Green	A/O	12,000	50	500
727399		2	1/4-20	HS Medium	Blue	A/O	12,000	50	500
727400		2	1/4-20	HP Very Fine	Red	A/O	12,000	50	500
727401	3" x 3/4"	2	1/4-20	HS Coarse	Green	A/O	8,000	50	500
727402		2	1/4-20	HS Medium	Blue	A/O	8,000	50	500
727403		2	1/4-20	HP Very Fine	Red	A/O	8,000	50	500

Combi Cross Buffs

- Incorporating both Buff & Blend and Coated Abrasive materials for greater stock removal
- Very flexible and provides clean burr-free finishes
- Grit ranges from 60 to 320



PART NO.	SIZE x WIDTH	PLY	EYELET	GRADE	COLOR	GRAIN	MAX. R.P.M.	MIN. PKG.	CASE QTY.
727404	2" x 1/2"	2	8-32	GP Medium 60	Maroon	A/O	12,000	25	250
727405		2	8-32	GP Medium 80	Maroon	A/O	12,000	25	250
727406		2	8-32	HP Very Fine 120	Red	A/O	12,000	25	250
727407		2	8-32	HP Very Fine 240	Red	A/O	12,000	25	250
727408	3" x 3/4"	2	1/4-20	GP Medium 60	Maroon	A/O	8,000	25	250
727409		2	1/4-20	GP Medium 80	Maroon	A/O	8,000	25	250
727410		2	1/4-20	HP Very Fine 120	Red	A/O	8,000	25	250
727411		2	1/4-20	HP Very Fine 240	Red	A/O	8,000	25	250

Blue part numbers indicate in-stock products.

Standard Abrasives™
Buff & Blend Rolls

Used with vibratory orbital and straight-line sanders, to produce matte and satin finishes. Rolls are also cut to size and used by hand or to finish a part turning on a lathe or spindle.

Deburring: Edge deburring on Aluminum extrusions; deburring Aluminum die cast flashing, radius edges on precision machined parts, and contoured parts; removing micro burrs.

Cleaning: Removing heavy surface oxidation and surface coatings for part inspection; surface preparation prior to coating; removing rust.

Blending: Blending mill marks, tool marks, mismatches, and coated abrasive disc scratch patterns; reducing uneven edges.

Finishing: Matte finish on Aluminum and Steel enclosures; satin finish on large Stainless Steel surfaces.



- Width fits most power sanders
- Waterproof; may be used with lubricants
- Resists loading; no metal contamination to work piece

GRADE	GRAIN	COLOR			GP			HS		HP	
		GP	HS	HP	2" x 30"	4" x 30'	6" x 30'	4" x 30'	6" x 30'	4" x 30'	6" x 30'
Coarse	A/O	–	Green	–	–	–	–	–	830130	–	–
Medium	A/O	Maroon	Blue	–	800082	830010	830011	830270	830271	–	–
Fine	A/O	Maroon	–	–	800081	830015	830016	–	–	–	–
Very Fine	A/O	Maroon	Maroon	Red	830042	830020	830021	830170	830171	830070	830071
Very Fine	S/C	Gray	–	–	–	830025	830026	–	–	–	–
Min. Pkg.					1	1	1	1	1	1	1

Other sizes available. Call for delivery and minimums.

Standard Abrasives recommends "Very Fine" grade for most "Fine" grade applications. For medium grade material, Standard Abrasives recommends its HS material.

FELT POLISHING DISCS

Standard Abrasives™
Felt Polishing Discs

Felt Discs are designed for the final polishing process. When used on a scratched or rough piece of metal, first remove scratches with Surface Conditioning & Deburring Discs. Begin polishing with a Buff & Blend Disc, and use Felt Discs for the final finish.

Final Finishing: On Aluminum, Brass and Chrome, when used with a metal polish.

Polishing: On small or tight areas, using small diameter discs or on large, open areas, using large diameter discs.



SIZE	TS PART NO.	TR PART NO.	MAX. R.P.M.	MIN. PKG.	CASE QTY.
1"	840100	–	20,000	10	100
2"	840300	840380	20,000	10	100
3"	840400	840480	18,000	10	100

- Instant disc changes with Quick Change TS or TR fastening systems; disc is centered for smooth running
- Cool running; reduces risk of loading
- Flexible; conforms to contours, radius and I.D. areas; prevents undercutting or gouging of the work piece

Holder Pads for Felt Polishing Discs

TS PAD ONLY	TS PAD w/TA4 MANDREL	DIA.	DENSITY	DESCR.	MAX. R.P.M.
541002	541052	1"	Medium	SM 1	40,000
541006	541056	2"	Soft	SS 2	20,000
541007	541057	2"	Medium	SM 2	25,000
541008	541058	2"	Firm	SF 2	30,000
541009	541059	3"	Soft	SS 3	12,000
541010	541060	3"	Medium	SM 3	20,000
541011	541061	3"	Firm	SF 3	20,000

TR PAD ONLY	TR PAD w/TA4 MANDREL	DIA.	DENSITY	DESCR.	MAX. R.P.M.
546006	546056	2"	Soft	LS 2	20,000
546007	546057	2"	Medium	LM 2	25,000
546008	546058	2"	Firm	LF 2	30,000
546009	546059	3"	Soft	LS 3	12,000
546010	546060	3"	Medium	LM 3	20,000
546011	546061	3"	Firm	LF 3	20,000

All TS and TR holder pads have 1/4-20 female thread.
1/4" TA4 Mandrel available separately, part number 540013.

Blue part numbers indicate in-stock products.

Standard Abrasives™ Hand Pads

Designed for hand applications such as deburring, polishing, cleaning, finishing, and surface preparation on metal composite or plastic surfaces. They can replace steel wool, files, scrapers, wire brushes and sandpaper sheets.



HAND PAD MATERIALS						
Heavy Duty	Gen. Purpose	Ultra Fine	Cleaning	Industrial	Commercial	Power Pad

PRODUCT APPLICATIONS	Heavy Duty	Gen. Purpose	Ultra Fine	Cleaning	Industrial	Commercial	Power Pad
Deburr	•	•	•	•			•
Clean	•	•	•	•	•	•	•
Polish	•	•	•	•			•
Finish	•	•	•	•	•		
Surface Preparation	•	•	•	•			•
PRODUCT FEATURES							
Non-rusting; will not contaminate work piece	•	•	•	•	•	•	•
Waterproof; may be used with solvents	•	•	•	•	•		•
Flexible, conforms to work piece	•	•	•	•	•	•	•
Uniform distribution of grain; consistent finish	•	•	•	•	•	•	•
Pre-cut 6" x 9" size eliminates need to cut rolls	•	•	•	•	•	•	•
Non-Rusting	•	•	•	•	•	•	•

General Hand Pads

- Washable; reusable and rust proof
- Various grades adapt to specific jobs

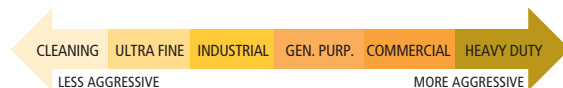

PART NO.	DESCRIPTION	GRAIN	COLOR	SIZE	MIN. PKG.
827510	Heavy Duty	A/O	Tan	6" x 9"	1 Case = 40 Pads
827505	General Purpose	A/O	Maroon	6" x 9"	1 Case = 60 Pads
827500	Ultra Fine	S/C	Gray	6" x 9"	1 Case = 60 Pads
827525	Cleaning	-	White	6" x 9"	1 Case = 60 Pads

Power Pads

- Designed for power applications; used with Jitterbug, orbital and straight line sanders
- Added strength, toughness and power

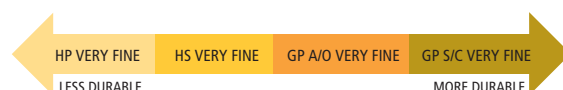

PART NO.	DESCRIPTION	GRAIN	COLOR	SIZE	MIN. PKG.
827600	GP Very Fine	A/O	Maroon	6" x 9"	1 Case = 50 Pads
827605	GP Very Fine	S/C	Gray	6" x 9"	1 Case = 50 Pads
827620	HP Very Fine	A/O	Red	6" x 9"	1 Case = 50 Pads
827630	HS Very Fine	A/O	Pink	6" x 9"	1 Case = 50 Pads

Blue part numbers indicate in-stock products.

Industrial Scouring Hand Pads

- Tough cleaning and scouring applications in the food service industry
- Light duty cleaning; removing light oxidation and rust
- Tough and durable high grade resin system
- May be used dry or with solvents or water-based detergents



PART NO.	DESCRIPTION	GRAIN	COLOR	SIZE	MIN. PKG.
827520	Industrial Grade	A/O	Green	6" x 9"	1 Case = 60 Pads

Hand Pad Holder

PART NO.	DESCRIPTION	COLOR	MIN. PKG.
827000	Hand Pad Holder	Orange	1

Blue part numbers indicate in-stock products.



Standard Abrasives™
Cleaning Discs

Cleaning Discs are ideal for cleaning welds, removing corrosion, rust, scale, paints, varnishes and sealants from difficult to reach surfaces. Constructed of large nylon filament, they are an open, non-loading structure that performs rapid removal of surface contaminants, while producing fine finishes. Also used for blending.



- Coarse Silicon Carbide grain for rapid removal of surface contaminants

Cleaning Discs, Standard

PART NO.	SIZE	DESCRIPTION	COLOR	MAX. R.P.M.	MIN. PKG.	CASE QTY.
840397	2"	Quick Change TS	Black	12,000	25	250
840497	3"	Quick Change TS	Black	8,500	10	100
843890	4 1/2"	Quick Change TS	Black	6,000	5	50
843990	5"	Quick Change TS	Black	6,000	5	50
840398	2"	Quick Change TR	Black	12,000	25	250
840498	3"	Quick Change TR	Black	8,500	10	100
811027	4 1/2" x 7/8"	Type 27 Disc	Black	10,000	5	50
843401	4" x 1/4"	Arbor Hole Disc	Black	6,000	10	100
840701	6" x 1/2"	Arbor Hole Disc	Black	4,000	5	50
840901	8" x 1/2"	Arbor Hole Disc	Black	3,000	5	50
880493	3" x 1 Ply	Spindle Mounted Wheel	Black	10,000	5	50
880495	3" x 2 Ply	Spindle Mounted Wheel	Black	10,000	5	50

Additional sizes are available. Call for delivery and minimums.

Cleaning Discs Pro

- Additional grain and resin reinforcement for aggressiveness, fast and even material removal, and increased durability on edges

PART NO.	SIZE	DESCRIPTION	COLOR	MAX. R.P.M.	MIN. PKG.	CASE QTY.
840396	2"	Quick Change TS - SocAtt	Blue	12,000	25	250
840496	3"	Quick Change TS - SocAtt	Blue	8,500	10	100
840399	2"	Quick Change TR - Lockit	Blue	12,000	25	250
840499	3"	Quick Change TR - Lockit	Blue	8,500	10	100
811127	4 1/2" x 7/8"	Type 27 Disc	Blue	10,000	5	50
843402	4" x 1/4"	Arbor Hole Disc	Blue	6,000	10	100
840702	6" x 1/2"	Arbor Hole Disc	Blue	4,000	5	50
840902	8" x 1/2"	Arbor Hole Disc	Blue	3,000	5	50

Additional sizes are available. Call for delivery and minimums.

Holder Pads for Cleaning Discs

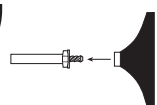

PAD MANDRELS		
PART NO.	DESCRIPTION	SIZE
540013	TA 4	1/4" Mandrel
440025	TA 6	6 MM Mandrel

ATTACHMENT SYSTEM	PAD ONLY PART NO.	PAD w/TA4 MANDREL PART NO.	DIAMETER	DENSITY	DESCRIPTION	MAXIMUM R.P.M.
TS	541006	541056	2"	Soft	SS 2	20,000
	541007	541057	2"	Medium	SM 2	25,000
	541008	541058	2"	Firm	SF 2	30,000
	541009	541059	3"	Soft	SS 3	12,000
	541010	541060	3"	Medium	SM 3	20,000
	541011	541061	3"	Firm	SF 3	20,000
TR	546006	546056	2"	Soft	LS 2	20,000
	546007	546057	2"	Medium	LM 2	25,000
	546008	546058	2"	Firm	LF 2	30,000
	546009	546059	3"	Soft	LS 3	12,000
	546010	546060	3"	Medium	LM 3	20,000
	546011	546061	3"	Firm	LF 3	20,000

All TS and TR holder pads have 1/4-20 female thread.

TS HOLDER PADS FOR DISCS WITH 5/8-11 HUB					
SYSTEM	PART NO.	DIA.	DENSITY	DESCR.	MAX. R.P.M.
TS	543630	4 1/2"	Medium	SM 45 F	18,000
	543632	5"	Medium	SM 55 F	18,000

PAD ADAPTERS	
PART NO.	SIZE
547003	5/8-11M x 3/8-24F
547008	5/8-11M x 5/8-11F
547024	5/8-11M x 1/2-13F

*BD – Low Profile Holder Pad fits Black & Decker. Replacement pad part number 542012. Holder Pads have 5/8"-11 female thread.

Standard Abrasives™
Convolute Wheels

Used for deburring, blending, finishing, polishing and cleaning applications that will not break edges or remove metal, these wheels are used on automated equipment, straight shaft stationary and portable tools and feed-through machines.

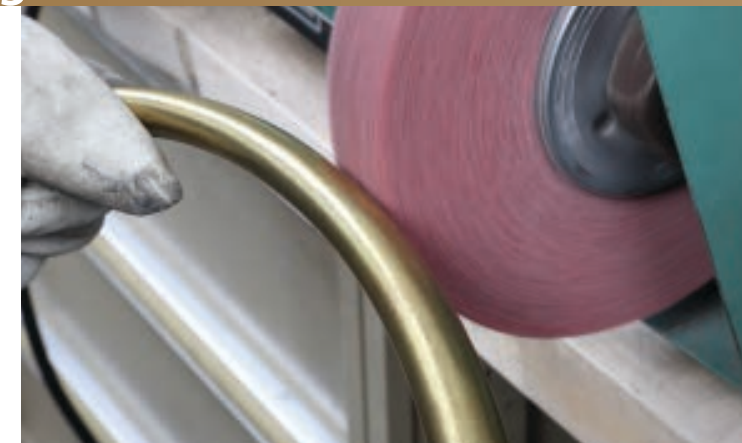

GP Plus Wheels – These wheels provide the highest durability for the toughest edge and flat surface deburring applications, producing a smear resistant finish, while maintaining wheel shape in the most aggressive applications.

Deburring Wheels – They provide an excellent starting point for medium to heavy precision deburring, blending and polishing, especially where seams and welds require smoothing.

LDW (Light Deburring Wheel) – These are the ideal wheels for light deburring of parts with critical tolerances. Maintain a smear resistant, bright polished finish from part to part. Softer densities provide greater control.

Metal Finishing Wheels – The "Red" 'Wheels' durable construction provides users with a long-lasting finishing wheel for decorative satin and antique finishing of Stainless Steel, Brass and Aluminum.

Multi-Finish Wheels – These low density, durable wheels are used primarily for applications requiring a linear scratch and final finish on surfaces where no edges or burrs are present.

General Purpose Wheels – Good, every day performance for light-medium deburring, edge radiusing, and finishing of all metals.

WHAT THE NUMBERS REPRESENT IN "SPEC" DESCRIPTIONS:

Density 2 = Extra Soft 5 = Soft 6 = Soft/Medium 7 = Medium/Hard 8 = Hard 9 = Extra Hard 10 = Hardest	Grain A = A/O S = S/C	Grade F = Fine M = Medium C = Coarse	Example: 8AM Wheel = 8 A M Hard Density A/O Grain Medium Grade
--	------------------------------------	--	---



CONVOLUTE WHEEL LINE

PRODUCT APPLICATIONS	CONVOLUTE WHEEL LINE					
	MULTI-FINISH	GP PLUS	DEBURRING	LDW	METAL FINISH	GEN. PURP.
DEBURR		10SF 9SF 8SF		7SF		9SF
CLEAN		8AM 8SF		8SF 7SF		9SF
BLEND		10SF 9SF 8SF		7SF		
FINISH		8AM			6AM 5AM	9SF
Burr Removal		•	•	•		•
Machine and Belt Mark Blending		•		•	•	•
Final Finishing	•			•	•	•
FEATURES						
Edge Durability - Maintains wheel integrity even with additional pressure		•	•	•		
Smooth Running - Less operator fatigue	•	•	•	•	•	•
Non-Metallic - No contamination of work piece	•	•	•	•	•	•
Fast Cut Rate - More parts per time reducing labor cost and increasing capacity		•			•	
Conforms to Work Piece - Prevents undercutting and gouging the work piece	•	•	•	•	•	•
Smear Resistant	•	•	•	•	•	•
GRADES						
Coarse	•					
Medium	•	•	•	•	•	•
Fine		•	•	•		•

GP Plus Convolute Wheels

- Best wheel for deburring, blending and cleaning when a consistent cut rate and wheel durability are a primary requirement
- Fast, effortless (high cut rate even at lower pressures); fast removal of burrs and edge breaking
- Remove medium to heavy burrs, deburr turbine blades and heavy edges
- Blend machine, tool and belt marks
- Fine finishing on surgical tools; final finishing
- Provides best durability, stock removal and finest finish



SPEC.	GRADE	GRAIN	6" x 1/2" x 1"	6" x 1" x 1"	6" x 2" x 1"	8" x 1/2" x 3"	8" x 1" x 3"	8" x 2" x 3"	12" x 1/2" x 5"	12" x 1" x 5"	12" x 2" x 5"	14" x 2" x 8"	14" x 2" x 8"
Medium	8AM	A/O	853042	853142	–	853742	853342	853442	850286	853942	853842	–	–
Fine	8SF	S/C	853053	853153	–	853753	853353	853453	850256	853953	853853	–	–
Medium	8SM	S/C	853052	853152	853252	853752	853352	853452	850344	853952	–	–	–
Fine	9SF	S/C	854053	854153	854253	854753	854353	854453	850257	854953	854853	850285	850268
Fine	10SF	S/C	855053	855153	–	855753	855353	–	–	855953	855853	–	–
Fine	11SF	S/C	850345	850153	–	–	850353	850453	–	850953	850853	–	–
Max. R.P.M.			6,000	6,000	–	4,500	4,500	4,500	3,000	3,000	3,000	2,550	2,550
Min. Pkg.			1	1	1	1	1	1	1	1	1	1	1
Case Qty.			4	3	2	4	3	2	2	2	1	1	1

Additional sizes are available. Same specifications available in 14" diameter. Call for delivery and minimums.

Metal Finishing Convolute Wheels

- Ideal for imparting decorative satin and antique finishes
- Blend scratches while applying a burr-free finish for coating and polishing
- Can be dressed to fit a specific part geometry
- Durable; withstands greater contact pressures and speed variations



GRADE	SPEC.	GRAIN	6" x 1/2" x 1"	6" x 1" x 1"	6" x 2" x 1"	8" x 1" x 3"	8" x 2" x 3"	12" x 1/2" x 5"	12" x 1" x 5"	12" x 2" x 5"
Medium	4AM	A/O	–	–	–	857382	857482	–	–	–
Medium	5AM	A/O	858082	858182	858282	858382	858482	850171	858982	858882
Medium	6AM	A/O	–	859182	859282	859382	859482	–	859982	–
Max. R.P.M.			6,000	6,000	6,000	4,500	4,500	3,000	3,000	3,000
Min. Pkg.			1	1	1	1	1	1	1	1
Case Qty.			4	3	2	3	2	2	2	1

Additional sizes and grades available. Call for specific product information regarding your request.

Blue part numbers indicate in-stock products.

Multi-Finish Convolute Wheels

- Blending coated abrasive scratches and surfaces to match #4 mill finish
- Applying burr free satin finish to architectural hardware and grain finish prior to anodizing; consistent and clean smear resistant grain finishes
- Low Density produces large "footprint" on the work piece
- Even attrition; does not "chunk" or dust.



GRADE	SPEC.	GRAIN	6" x 1" x 1"	6" x 2" x 1"	6" x 3" x 1"	8" x 1" x 3"	8" x 2" x 3"	12" x 1" x 5"	12" x 2" x 5"
Fine	2SF	S/C	–	–	–	–	–	856993	–
Medium	2SM	S/C	856192	856292	850306	856392	856492	856992	856892
Coarse	2SC	S/C	856191	856291	850307	856391	856491	856991	856891
Max. R.P.M.			6,000	6,000	6,000	4,500	4,500	3,000	3,000
Min. Pkg.			1	1	1	1	1	1	1
Case Qty.			3	2	2	3	2	2	1

Multi-Finish Convolute Wheels are also recommended for most final finishing applications. Additional sizes and grades available. Call for specific product information regarding your request.

General Purpose Convolute Wheels

- Great versatility! Standard Abrasives General Purpose Wheels are ideal for a wide range of shop jobs, including:
- Light to medium deburring
 - Edge radiusing
 - Cleaning / finishing
 - Light defect removal



GRADE	SPEC.	GRAIN	6" x 1/2" x 1"	6" x 1" x 1"	8" x 1/2" x 3"	8" x 1" x 3"
Fine	9SF	S/C	850373	850374	850375	850376
Max. R.P.M.			6,000	6,000	4,500	4,500
Min. Pkg.			1	1	1	1
Case Qty.			5	5	5	5

Additional sizes and grades available. Call for specific product information regarding your request.

Available for individual sale.

Blue part numbers indicate in-stock products.

Deburring Convolute Wheels

- Excellent starting point for medium to heavy deburring and polishing
- Remove medium to heavy burrs and parting lines from castings and forgings; deburr Aluminum die cast flashing, Stainless Steel pipe threads, punched holes on machined parts; smooth radius on stamped metal parts
- Polish welds and small casted parts prior to coating; blend and polish handling marks



GRADE	DENSITY	SPEC.	GRAIN	6" x 1/2" x 1"	6" x 1" x 1"	6" x 2" x 1"	8" x 1/2" x 3"	8" x 1" x 3"	8" x 2" x 3"
Fine	Medium	8SF	S/C	853093	853193	–	853793	853393	853493
Fine	Hard	9SF	S/C	854093	854193	854293	854793	854393	854493
Fine	Hard	10SF	S/C	855093	855193	–	–	–	–
Max. R.P.M.				6,000	6,000	6,000	4,500	3,000	3,000
Min. Pkg.				1	1	1	1	1	1
Case Qty.				4	3	2	4	3	2

Additional sizes are available. Call for delivery and minimums.

LDW (Light Deburring Convolute Wheel)

- Best wheel for light deburring, blending machine and belt marks and finishing of small parts
- Softer wheel has greater flexibility
- Fast finish rate with less effort than competitive wheels; bright smear resistant finishes
- Polishing molds, dies and surgical tools
- Finishing prior to polishing



GRADE	SPEC.	GRAIN	6" x 1/2" x 1"	6" x 1" x 1"	6" x 2" x 1"	8" x 1/2" x 3"	8" x 1" x 3"	8" x 2" x 3"	12" x 1/2" x 5"	12" x 3/4" x 5"	12" x 1" x 5"	12" x 2" x 5"	14" x 2" x 8"	14" x 3" x 8"
Fine	6SF	S/C	851033	851133	–	851733	851333	–	–	–	851933	851833	–	–
Fine	7SF	S/C	852033	852133	852233	852733	852333	852433	850258	850357	852933	852833	850274	850324
Fine	8SF	S/C	853033	853133	–	853733	853333	–	850259	850333	853933	853833	850282	–
Max. R.P.M.			6,000	6,000	6,000	4,500	4,500	4,500	3,000	3,000	3,000	3,000	2,550	2,550
Min. Pkg.			1	1	1	1	1	1	1	1	1	1	1	1
Case Qty.			4	3	2	4	3	2	2	2	2	1	1	1

Additional sizes are available. Call for delivery and minimums.

Blue part numbers indicate in-stock products.

Flange Adapters for Convolute Wheels

PART NO.	USE WITH	MIN. PKG.
850088*	6" diameter Convolute Wheel with 1" center hole	1
850077	8" diameter Convolute Wheel with 3" center hole	1
850087	12" diameter Convolute Wheel with 5" center hole	1
850081	14" diameter Convolute Wheel with 8" center hole	1

*Also used to drive 6" diameter Unitized Wheels with 1" center hole

These flange adapters are made to order and machined for extra durability. To ensure size accuracy of flanges, when ordering, please specify Convolute Wheel outside diameter dimension and flange arbor hole size.

SPECIAL ORDER NOTICE: Call for standard hole sizes. Non-standard hole sizes available as Made-To-Order items; call for additional pricing, minimums and delivery.



Standard Abrasives™ Unitized Wheels

Used for tough deburring, blending, finishing and polishing on ferrous and non-ferrous materials. Unitized Wheels are bi-directional and can be mounted on a tool or pedestal grinder without regard to the spindle rotation direction.



500 Series – Soft density with exceptional conformability while maintaining durability, cut and consistent finish. For applications with strict dimension tolerances.

600 Series – Soft/Medium density with increased edge durability and life for tough blending and polishing applications.

700 Series – Medium/Hard density with increased edge durability and life for tough deburring and cleaning applications.

800 Series – Hard density with increased edge durability and life for tough deburring and polishing applications.

900 Series – Extra hard density with the highest edge durability, increasing productivity and capable of deburring and polishing harder metals.

WHAT THE NUMBERS REPRESENT IN "TYPE" DESCRIPTIONS:

Density 5 = Soft 6 = Soft/Medium 7 = Medium/Hard 8 = Hard 9 = Extra Hard	Grade 1 = Coarse 2 = Medium 3 = Fine	Grain 1 = A/O 2 = S/C 4 = S/C Firm* <small>*Available only as a Type 524</small>	Example: 521 Wheel = 5 2 1 Soft Density Medium Grade A/O Grain
--	--	---	---



PRODUCT APPLICATIONS	UNITIZED WHEEL LINE				
	500 SERIES	600 SERIES	700 SERIES	800 SERIES	900 SERIES
DEBURR		631	731	821	913, 993
CLEAN	521	631	731		921
BLEND	524	631		821	921
FINISH	532	632	732		921
PERFORMANCE CHARACTERISTICS					
Increased Durability - More productivity and longer lasting	•	•	•	•	•
Increased Edge Durability		•	•	•	•
Non-woven Construction - Resists loading	•	•	•	•	•
Non-metallic - No contamination of work piece	•	•	•	•	•
Smear Resistant Formula	•	•	•	•	•
Conforms to Work Piece - Prevents undercutting/gouging; less operator fatigue	•	•	•	•	•
MATERIALS					
FERROUS	•	•	•	•	•
NON-FERROUS	•	•	•	•	•
ALUMINUM	•	•	731	821	
STAINLESS STEEL	•	•	•	•	•
HIGH NICKEL/CHROME ALLOYS	•	•	•	•	•
TITANIUM	532	632	732		
COMPOSITES	•	•	•		
GRADES					
Coarse				•	•
Medium	•			•	•
Fine	•	•	•		

500 Series Unitized Wheels

CLEANING

- General purpose cleaning; cleaning prior to painting
- Removing rust, discoloration from welds, minor pits and scratches, resins/adhesives overspray and coating

POLISHING

- Polishing fillet areas on jet blades
- Polishing soft metals prior to coating process



PART NO.	SIZE	TYPE	DENSITY	GRAIN	GRADE	MAX. R.P.M.	MIN. PKG.	CASE QTY.
890382	1" x 1/4" x 1/16"	524	Soft	S/C	Medium	18,000	100	100
853201	1" x 1/4" x 1/8"	532	Soft	S/C	Fine	18,000	–	10
853230	1" x 1/4" x 1/4"	532	Soft	S/C	Fine	18,000	10	10
890270	1" x 1/4" x 3/16"	532	Soft	S/C	Fine	18,000	10	10
852105	1" x 1" x 3/16"	521	Soft	A/O	Medium	20,000	10	10
852405		524	Soft	S/C	Medium	20,000	10	10
853205		532	Soft	S/C	Fine	20,000	10	10
890344	1 1/2" x 1" x 1/4"	532	Soft	S/C	Fine	20,000	10	10
852109	2" x 1/4" x 1/8"	521	Soft	A/O	Medium	18,000	10	10
890196		532	Soft	S/C	Fine	18,000	–	10
852413	2" x 1/4" x 3/16"	524	Soft	S/C	Medium	18,000	10	10
853213		532	Soft	S/C	Fine	18,000	10	10
852110	2" x 1/4" x 1/4"	521	Soft	A/O	Medium	18,000	10	10
852410		524	Soft	S/C	Medium	18,000	10	10
853210		532	Soft	S/C	Fine	18,000	10	10
852115	2" x 1/2" x 1/4"	521	Soft	A/O	Medium	18,000	10	10
853215		532	Soft	S/C	Fine	18,000	10	10
890386	2" x 1" x 1/16"	532	Soft	S/C	Fine	18,000	10	10
853221	2" x 1" x 1/4"	532	Soft	S/C	Fine	18,000	10	10
852135	3" x 1/4" x 1/4"	521	Soft	A/O	Medium	12,000	10	10
852435		524	Soft	S/C	Medium	12,000	10	10
853235		532	Soft	S/C	Fine	12,000	10	10
852437	3" x 1/4" x 3/8"	524	Soft	S/C	Medium	12,000	10	10
853237		532	Soft	S/C	Fine	12,000	10	10
852140	3" x 1/2" x 1/4"	521	Soft	A/O	Medium	12,000	10	10
853240		532	Soft	S/C	Fine	12,000	10	10
853250	3" x 1" x 1/4"	532	Soft	S/C	Fine	12,000	10	10
852454	4" x 1/4" x 1/4"	524	Soft	S/C	Medium	12,000	10	10
853254		532	Soft	S/C	Fine	12,000	10	10
852455	4" x 1/4" x 3/8"	524	Soft	S/C	Medium	12,000	10	10
853255		532	Soft	S/C	Fine	12,000	10	10
890317	5" x 1/4" x 1/4"	524	Soft	S/C	Medium	12,000	1	10
890244		532	Soft	S/C	Fine	12,000	1	10
890170	6" x 1/4" x 1/4"	532	Soft	S/C	Fine	6,000	1	10
852173	6" x 1/4" x 1/2"	521	Soft	S/C	Medium	6,000	1	10
852473		524	Soft	S/C	Medium	6,000	1	10
853273		532	Soft	S/C	Fine	6,000	1	10
890399	6" x 1/4" x 3/4"	524	Soft	S/C	Medium	12,000	–	10
890098		532	Soft	S/C	Fine	12,000	1	10
853274	6" x 1/4" x 1"	532	Soft	S/C	Fine	6,000	1	10
852171	6" x 1/2" x 1/2"	521	Soft	A/O	Medium	6,000	1	4
852671		524	Soft	S/C	Medium	6,000	1	4
852471		524	Soft	S/C	Medium	6,000	1	4
853271		532	Soft	S/C	Fine	6,000	1	4
852481	6" x 1/2" x 5/8"	524	Soft	S/C	Medium	6,000	1	4
852175	6" x 1/2" x 1"	521	Soft	A/O	Medium	6,000	1	4
852675		524	Soft	S/C	Medium	6,000	1	4
852475		524	Soft	S/C	Medium	6,000	1	4
853275		532	Soft	S/C	Fine	6,000	1	4
852178	6" x 1" x 1"	521	Soft	A/O	Medium	6,000	1	3
852478		524	Soft	S/C	Medium	6,000	1	3
853278		532	Soft	S/C	Fine	6,000	1	3

Blue part numbers indicate in-stock products.

Continued next page

500 Series Unitized Wheels

Continued from previous page

PART NO.	SIZE	TYPE	DENSITY	GRAIN	GRADE	MAX. R.P.M.	MIN. PKG.	CASE QTY.
890201	12" x 1/4" x 1 1/4"	524	Soft	S/C	Medium	2,300	1	10
890281	12" x 1/2" x 3/4"	524	Soft	S/C	Medium	2,300	–	1
890274		532	Soft	S/C	Fine	2,300	–	1
890094	12" x 1/2" x 1 1/4"	524	Soft	S/C	Medium	2,300	1	1
890332		524	Soft	S/C	Medium	2,300	1	5
890231		532	Soft	S/C	Fine	2,300	1	1
890328	12" x 1/2" x 2"	524	Soft	S/C	Medium	2,300	–	1
890331	12" x 1 x 1 1/4"	524	Soft	S/C HP	Medium	2,300	1	5
890080		524	Soft	S/C	Medium	2,300	1	2
890219		532	Soft	S/C	Fine	2,300	1	1
890327	12" x 1" x 2"	524	Soft	S/C	Medium	2,300	1	1
TS QUICK CHANGE STYLE								
853225	3" x 1/4"	532	Soft	S/C	Fine	18,000	–	10
TR QUICK CHANGE STYLE								
852199	2" x 1/4"	521	Soft	A/O	Medium	18,000	10	10
852499		524	Soft	S/C	Medium	18,000	10	10
853299		532	Soft	S/C	Fine	18,000	10	10
852498	3" x 1/4"	524	Soft	S/C	Medium	12,000	10	10
853298		532	Soft	S/C	Fine	12,000	10	10
852198		521	Soft	A/O	Medium	12,000	10	10

Additional sizes and grades for Unitized Wheels are available. Call for specific product information regarding your request.

Holder Pads for Quick Change Style

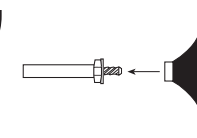

PAD MANDRELS		
PART NO.	DESCRIPTION	SIZE
540013	TA 4	1/4" Mandrel
440025	TA 6	6 MM Mandrel
541034	–	1/4" Mini Track Mandrel

ATTACHMENT SYSTEM	PAD ONLY PART NO.	PAD w/TA4 MANDREL PART NO.	DIAMETER	DENSITY	DESCRIPTION	MAXIMUM R.P.M.
TS	541006	541056	2"	Soft	SS 2	20,000
	541007	541057	2"	Medium	SM 2	25,000
	541008	541058	2"	Firm	SF 2	30,000
	541009	541059	3"	Soft	SS 3	12,000
	541010	541060	3"	Medium	SM 3	20,000
	541011	541061	3"	Firm	SF 3	20,000
TR	546006	546056	2"	Soft	LS 2	20,000
	546007	546057	2"	Medium	LM 2	25,000
	546008	546058	2"	Firm	LF 2	30,000
	546009	546059	3"	Soft	LS 3	12,000
	546010	546060	3"	Medium	LM 3	20,000
	546011	546061	3"	Firm	LF 3	20,000

All TS and TR holder pads have 1/4-20 female thread.

1/4" TA4 Mandrel available separately, part number 540013.

Blue part numbers indicate in-stock products.

700 Series Unitized Wheels

Continued from previous page

PART NO.	SIZE	TYPE	DENSITY	GRAIN	GRADE	MAX. R.P.M.	MIN. PKG.	CASE QTY.
TS QUICK CHANGE STYLE								
873225	3" x 1/4"	732	Medium/Hard	S/C	Fine	18,000	–	10
TR QUICK CHANGE STYLE								
872199	2" x 1/4"	721	Medium/Hard	A/O	Medium	18,000	–	10
873199		731	Medium/Hard	A/O	Fine	18,000	10	10
873299		732	Medium/Hard	S/C	Fine	18,000	–	10
873197	3" x 1/8"	731	Medium/Hard	A/O	Fine	12,000	10	10
873297		732	Medium/Hard	S/C	Fine	12,000	–	10
872198	3" x 1/4"	721	Medium/Hard	A/O	Medium	12,000	10	10
873198		731	Medium/Hard	A/O	Fine	12,000	10	10
873298		732	Medium/Hard	S/C	Fine	12,000	10	10

Additional sizes and TS Quick Change style are available. Call for delivery and minimums.

See page 61 for Quick Change Style holder pads.

800 Series Unitized Wheels

DEBURRING

- Deburring Stainless Steel pipe thread, wire edges from surgical instruments, Stainless Steel sinks, tanks and other equipment for the food service industry
- Deburring gears and aircraft wing spars
- Breaking edges on Aluminum extrusions

POLISHING

- Polishing Stainless Steel rule dies
- Polishing welds on Stainless Steel sinks
- Polishing machined surfaces and hand tools
- Polishing round tubing

PART NO.	SIZE	TYPE	DENSITY	GRAIN	GRADE	MAX. R.P.M.	MIN. PKG.	CASE QTY.
882100	1" x 1/8" x 1/8"	821	Hard	A/O	Medium	30,000	–	10
882103	1" x 1/2" x 3/16"	821	Hard	A/O	Medium	30,000	–	10
881105	1" x 1" x 3/16"	811	Hard	A/O	Coarse	30,000	10	10
882105		821	Hard	A/O	Medium	30,000	10	10
882107	2" x 1/8" x 1/8"	821	Hard	A/O	Medium	22,000	–	10
881108	2" x 1/8" x 1/4"	811	Hard	A/O	Coarse	22,000	10	10
882108		821	Hard	A/O	Medium	22,000	10	10
881110	2" x 1/4" x 1/4"	811	Hard	A/O	Coarse	22,000	–	10
882110		821	Hard	A/O	Medium	22,000	10	10
882115	2" x 1/2" x 1/4"	821	Hard	A/O	Medium	22,000	10	10
882120	2" x 3/4" x 1/4"	821	Hard	A/O	Medium	22,000	5	5
882121	2" x 1" x 1/4"	821	Hard	A/O	Medium	22,000	5	5
882133	3" x 1/8" x 1/4"	821	Hard	A/O	Medium	18,000	10	10
881135	3" x 1/4" x 1/4"	811	Hard	A/O	Coarse	18,000	10	10
882135		821	Hard	A/O	Medium	18,000	10	10
882137	3" x 1/4" x 3/8"	821	Hard	A/O	Medium	18,000	–	10
882141	3" x 1/2" x 3/8"	821	Hard	A/O	Medium	18,000	–	10
882146	3" x 3/4" x 3/8"	821	Hard	A/O	Medium	18,000	10	10
881140	3" x 1/2" x 1/4"	811	Hard	A/O	Coarse	18,000	10	10
882140		821	Hard	A/O	Medium	18,000	10	10
882150	3" x 1" x 1/4"	821	Hard	A/O	Medium	18,000	10	100
882149	3" x 1" x 3/8"	821	Hard	A/O	Medium	18,000	10	10
890068	4" x 1/8" x 1/4"	821	Hard	A/O	Medium	10,000	–	10

Blue part numbers indicate in-stock products.

Continued next page

800 Series Unitized Wheels

Continued from previous page

PART NO.	SIZE	TYPE	DENSITY	GRAIN	GRADE	MAX. R.P.M.	MIN. PKG.	CASE QTY.
890294	6" x 1/8" x 1/4"	821	Hard	A/O	Medium	6,000	1	10
892170	6" x 1/8" x 1/2"	821	Hard	A/O	Medium	6,000	1	10
892172	6" x 1/8" x 1"	821	Hard	A/O	Medium	6,000	1	10
882173	6" x 1/4" x 1/2"	821	Hard	A/O	Medium	6,000	1	10
881168	6" x 1/4" x 5/8"	811	Hard	A/O	Coarse	6,000	1	10
890315	6" x 1/4" x 7/8"	821	Hard	A/O	Medium	6,000	1	10
882174	6" x 1/4" x 1"	821	Hard	A/O	Medium	6,000	1	10
882175	6" x 1/2" x 1"	821	Hard	A/O	Medium	6,000	1	4
881171	6" x 1/2" x 1/2"	811	Hard	A/O	Coarse	6,000	1	4
882171		821	Hard	A/O	Medium	6,000	1	4
881178	6" x 1" x 1"	811	Hard	A/O	Coarse	6,000	1	3
882178		821	Hard	A/O	Medium	6,000	1	3
TS QUICK CHANGE STYLE								
882125	3" x 1/4"	821	Hard	A/O	Medium	18,000	–	10
TR QUICK CHANGE STYLE								
881199	2" x 1/4"	811	Hard	A/O	Coarse	18,000	10	10
882199	2" x 1/4"	821	Hard	A/O	Medium	18,000	10	10
881197	3" x 1/8"	811	Hard	A/O	Coarse	12,000	10	10
882197		821	Hard	A/O	Medium	12,000	10	10
890245		821	Hard	A/O	Medium	12,000	–	50
881198	3" x 1/4"	811	Hard	A/O	Coarse	12,000	10	10
882198		821	Hard	A/O	Medium	12,000	10	10

Additional sizes and TS Quick Change style are available. Call for delivery and minimums.

See page 61 for Quick Change Style holder pads.

Blue part numbers indicate in-stock products.

Mandrels for Unitized Wheels



PART NO.	DESCRIPTION	SHANK LENGTH	SHANK DIAMETER	FOR USE WITH WHEEL DIAMETER	FOR USE WITH WHEEL THICKNESS
850034	Steel (A)	7/8"	1/4"	1"	1"
850030	Regular (B)	1 1/4"	1/4"	6"	1/2" - 1"
850029	Unitized Mandrel Combination (C)		1/4"	1 1/4" - 4"	1/8" - 1"
850031 †	Unitized Mandrel 3/8" Center Hole	1 1/4"	1/4"	2" - 3"	1/4" - 1/2"

*Combination features 4 screws (1/8", 1/4", 1/2", 1") and 1 mandrel base.

† Made for use with 913 and 993 Unitized Wheels only.

Blue part numbers indicate in-stock products.

**DEBURRING**

- Removal of heavy flash and parting lines
- Deburring sharp edges to a clean radius
- Removal of coarse coated abrasives grind lines
- Removal of heavy machine tool marks

BLENDING

- Blending of pits on cast parts
- Blending and surface refinement on high Nickel Alloys
- Blending machined surfaces where wheel rigidity is necessary

PART NO.	SIZE	TYPE	DENSITY	GRAIN	GRADE	MAX. R.P.M.	MIN. PKG.	CASE QTY.
891330 899330	1" x 1" x 1/4"	913 993	Extra Hard Extra Hard	C/O C/O	Coarse Extra Coarse	35,100 35,100	60 60	240 240
891108 892108	2" x 1/8" x 1/4"	911 921	Extra Hard Extra Hard	A/O A/O	Coarse Medium	18,000 18,000	10 10	10 10
891110 892110	2" x 1/4" x 1/4"	911 921	Extra Hard Extra Hard	A/O A/O	Coarse Medium	18,000 18,000	10 10	10 10
891133 892133	3" x 1/8" x 1/4"	911 921	Extra Hard Extra Hard	A/O A/O	Coarse Medium	12,000 12,000	10 10	10 10
891135 892135	3" x 1/4" x 1/4"	911 921	Extra Hard Extra Hard	A/O A/O	Coarse Medium	12,000 12,000	10 10	10 10
891337 899337	3" x 1/4" x 3/8"	913 993	Extra Hard Extra Hard	C/O C/O	Coarse Extra Coarse	18,100 18,100	40 40	160 160
891341 899341	3" x 1/2" x 3/8"	913 993	Extra Hard Extra Hard	C/O C/O	Coarse Extra Coarse	18,100 18,100	20 20	80 80
890389	4" x 1/8" x 1/4"	911	Extra Hard	A/O	Coarse	12,000	10	10
891154	4" x 1/4" x 1/4"	911	Extra Hard	A/O	Coarse	12,000	10	10
892155	4" x 1/4" x 3/8"	921	Extra Hard	A/O	Medium	12,000	10	10
890408 890409	5" x 1/4" x 7/8"	913 993	Extra Hard Extra Hard	C/O C/O	Coarse Extra Coarse	10,000 10,000	20 20	80 80
892173	6" x 1/4" x 1/2"	921	Extra Hard	A/O	Medium	12,000	1	10
891174 892174	6" x 1/4" x 1"	911 921	Extra Hard Extra Hard	A/O A/O	Coarse Medium	6,000 6,000	1 1	10 10
891375 899375	6" x 1/2" x 1"	913 993	Extra Hard Extra Hard	C/O C/O	Coarse Extra Coarse	7,500 7,500	4 4	16 16
TS QUICK CHANGE STYLE								
891125 892125	3" x 1/4"	911 921	Extra Hard Extra Hard	A/O A/O	Coarse Medium	12,000 12,000	10 10	10 10
TR QUICK CHANGE STYLE								
891199 891399 899399	2" x 1/4"	911 913 993	Extra Hard Extra Hard Extra Hard	A/O C/O C/O	Coarse Coarse Extra Coarse	18,000 22,100 22,100	10 15 10	10 60 40
892197	3" x 1/8"	921	Extra Hard	A/O	Medium	12,000	10	10
891198 891398 892198 899398	3" x 1/4"	911 913 921 993	Extra Hard Extra Hard Extra Hard Extra Hard	A/O C/O A/O C/O	Coarse Coarse Medium Extra Coarse	12,000 15,100 12,000 15,100	10 10 – 10	10 40 10 40

Additional sizes are available. Call for delivery and minimums.

See page 61 for Quick Change Style holder pads.



Standard Abrasives™ Type 27 Unitized Discs

Manufactured from the highest quality Unitized material. Unique design offers material removal while imparting a final finish. Used in conjunction with, and sometimes in lieu of, a coated abrasive Resin Fiber Disc or Flap Disc. Applications include deburring, cleaning, edge breaking, final finishing, blending and polishing.

SERIES 524

- Similar to Series 532, but with extra layer for durability.
- Provides greater rigidity than Series 532, for more precise finishing applications.
- Higher cut and finishing rate than Series 532.
- Ideal for high contact pressure applications where cut rate and durability are important.

SERIES 532

- Requires light pressure for fine finishing and polishing.
- Highly conformable.
- Provides clean, bright surface finish on Stainless Steel.
- Best when run at slower speeds for fine finishes.

SERIES 632

- Requires light pressure for fine finishing and polishing.
- Highly conformable.
- Provides clean, bright surface finish on Stainless Steel.
- Great product for blending tool marks and removing surface imperfections.

SERIES 732

- Requires light pressure for blending and finishing.
- High edge durability.
- High degree of stock removal, while maintaining a bright finish.
- Smaller contact area than Series 632.

SERIES 811

- Highest stock removal and edge breaking capability.
- Most aggressive for deburring.
- Capable of replacing 80 & 120 grit coated abrasive discs.

SERIES 821

- Hard density and medium grade provides high stock removal, while maintaining disc life and productivity.
- Very durable on an edge.
- Capable of replacing 100 & 120 grit coated abrasive discs.

SERIES 822

- Rapid stock removal, while providing a clean, bright surface.
- Most effective on Stainless Steel.
- High cut rate, with long life.

PART NO.	SIZE	SERIES	DENSITY	GRADE	GRAIN	MAX. R.P.M.	MIN. PKG.	CASE QTY.
811524	4 1/2"	524	Soft	Medium	S/C Firm	10,000	5	50
811532	4 1/2"	532	Soft	Fine	S/C	10,000	5	50
811632	4 1/2"	632	Soft/Medium	Fine	S/C	10,000	5	50
811732	4 1/2"	732	Medium/Hard	Fine	S/C	10,000	5	50
811811	4 1/2"	811	Hard	Coarse	A/O	10,000	5	50
811821	4 1/2"	821	Hard	Medium	A/O	10,000	5	50
811822	4 1/2"	822	Hard	Medium	S/C	10,000	5	50

5/8-11 thread also available. Call for delivery and minimums.

Blue part numbers indicate in-stock products.

SAFETY WARNING—Coated Abrasives are cutting tools and most of them are affixed to a drive member (holder pads, rubber drum, mandrel, etc.) and rotated at high speeds with a power tool. They should not be operated at higher than safe operating speeds. When using coated abrasives, safety glasses and gloves should be worn. Protective clothing may be required for continuous high speed grinding operations.

PRODUCT USE—All statements, technical information and recommendations contained in this document are based upon tests or experience that seller believes are reliable. However, many factors beyond seller's control can effect the use and performance of a seller's product in a particular application, including the conditions under which the product is used and the time and environments conditions in which the product is expected to perform. Since these factors are uniquely within the user's knowledge and control, it is essential that the user evaluate the seller's product to determine whether it is fit for a particular purpose and suitable for the user's method of application.

WARRANTY AND LIMITED REMEDY—Unless stated otherwise in seller's product literature, packaging inserts or product packaging for individual products, seller warrants that each seller's product meets the applicable specifications at the time seller ships the product. Individual products may have additional or different warranties as stated on product literature, package inserts or product packages. SELLER MAKES NO OTHER WARRANTIES, EXPRESSED OR IMPLIED, INCLUDING, BUT NOT LIMITED TO, ANY IMPLIED WARRANTY OF MERCHANTABILITY OR FITNESS FOR A PARTICULAR PURPOSE OR ANY IMPLIED WARRANTY ARISING OUT OF A COURSE OF DEALING, CUSTOM OR USAGE OF TRADE. User is responsible for determining whether the seller's product is fit for a particular purpose and suitable for user's application. If the seller's product is defective within the warranty period, your exclusive remedy and seller's sole obligation will be at seller's option, to replace the product or refund the purchase price.

LIMITATION OF LIABILITY—Except where prohibited by law, seller will not be liable for any loss or damage arising from the seller's product, whether direct, indirect, special, incidental, or consequential, regardless of the legal theory asserted, including warranty, contract, negligence, or strict liability.



Oak Hills, California 92344

For the distributor in your area call:

TOLL-FREE: 800-423-5444

FAX: 800-947-8263

www.standardabrasives.com

DISTRIBUTED BY: