

WIRING INSTRUCTIONS

TITLE

2 SPEED DEEP CUT BAND SAW

BULLETIN

MILWAUKEE ELECTRIC TOOL CORP. 13135 WEST LISBON RD. BROOKFIELD, WIS.

DATE
June '06

58-01-1200

NOTE: BE SURE LEADS ARE ROUTED BETWEEN COIL AND LAMINATION WHEN EXITING MOTOR HOUSING. FIELD INSULATOR TO BE LOCATED WITH NOTCH AT COMM. END TOP. ROUTE WIRE BUNDLE THROUGH NOTCH.

NOTE: WIRE NO. 10 IS PLACED THROUGH CONNECTOR C3. WIRE NO. 4 IS PLACED INTO THE TAP-IN SLOT IN LOCK CONNECTOR C3. BE SURE TO LOCK CONNECTOR SECURELY.

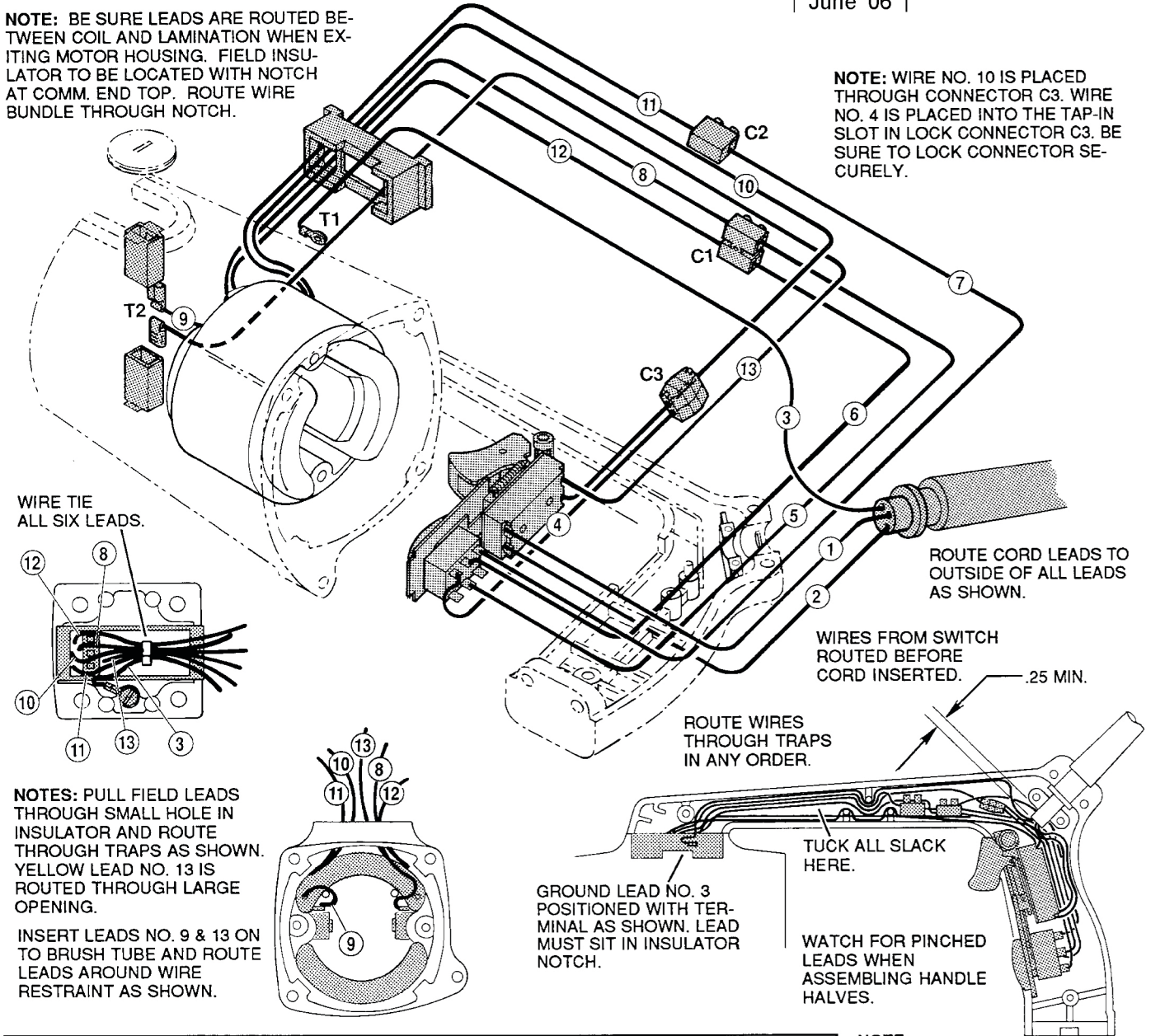

NOTES: PULL FIELD LEADS THROUGH SMALL HOLE IN INSULATOR AND ROUTE THROUGH TRAPS AS SHOWN. YELLOW LEAD NO. 13 IS ROUTED THROUGH LARGE OPENING.

INSERT LEADS NO. 9 & 13 ON TO BRUSH TUBE AND ROUTE LEADS AROUND WIRE RESTRAINT AS SHOWN.

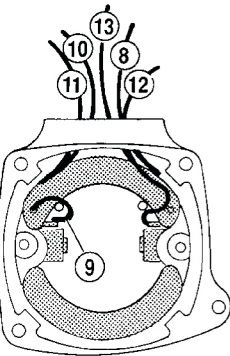

WIRING SPECIFICATIONS

Wire No.	Wire Color	Origin or Gauge	Length	Terminals, Connectors and 1 or 2 End Wire Preparation
1	White	Cord	3"	Strip 3/8" and tin.
2	Black	Cord	3"	Strip 3/8" and tin.
3	Green	Cord	9-1/4"	Strip 3/16" for T1.
4	Red	Switch	5-1/2"	For C3 (Do not strip or tin).
5	Black	Switch	6-1/4"	Strip 3/16" and tin for C1.
6	White	Switch	6-1/4"	Strip 3/16" and tin for C1.
7	Blue	Switch	7-1/2"	Strip 3/16" and tin for C2.
8	Black	Field	8-3/4"	Strip 3/16" and tin for C1.
9	Black or White	Field	1-3/4"	Strip 3/16" for T2.
10	Red	Field	11-3/4"	Strip 3/8" and tin.
11	Blue	Field	7-1/2"	Strip 3/16" and tin for C2.
12	White	Field	8-3/4"	Strip 3/16" and tin for C1.
13	Yellow	18Ga.	14"	Strip 3/16" for T2, Strip 3/8" and tin.

NOTE: All leads must be held to $\pm 1/8"$. All field leads to be measured from and perpendicular to laminations. All lead lengths are before stripping.

TERMINAL DESCRIPTION		
Code	Part No.	Qty.
T1	23-74-0840	1
T2	23-74-0750	2
CONNECTOR DESCRIPTION		
C1	22-56-0451	1
C2	22-56-0456	1
C3	22-56-0400	1