



3/4" DRIVE SHALLOW 12 POINT SOCKETS, SAE

High-Polished Chrome Finish



H-1240

H-1224

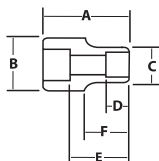

Product Code	Size (Inches)	A (Inches)	B (Inches)	C (Inches)	D (Inches)	E (Inches)	F (Inches)
H-1224	3/4	2	1 7/16	1 1/8	17/32	1 1/4	13/16
H-1226	13/16	2	1 7/16	1 7/32	9/16	1 1/4	13/16
H-1228	7/8	2	1 7/16	1 9/16	19/32	1 1/4	13/16
H-1230	15/16	2	1 7/16	1 3/8	21/32	1 1/4	13/16
H-1231	31/32	2	1 7/16	1 13/32	11/16	1 1/4	13/16
H-1232	1	2 1/16	1 7/16	1 15/32	11/16	1 5/16	25/32
H-1234	1 1/16	2 1/8	1 1/2	1 9/16	3/4	1 5/32	7/8
H-1236	1 1/8	2 3/16	1 1/2	1 5/8	13/16	1 7/32	29/32
H-1238	1 1/4	2 1/4	1 1/2	1 11/16	27/32	1 9/32	31/32
H-1240	1 1/4	2 1/4	1 1/2	1 3/4	27/32	1 11/32	15/16
H-1242	1 5/16	2 5/16	1 5/8	1 7/8	27/32	1 13/32	1
H-1244	1 3/8	2 5/16	1 5/8	1 15/16	7/8	1 3/8	1
H-1246	1 7/16	2 3/8	1 5/8	2	15/16	1 7/16	1
H-1248	1 1/2	2 1/2	1 5/8	2 1/8	1	1 9/16	1 1/8
H-1250	1 9/16	2 3/8	1 3/4	2 3/16	1 5/32	1 11/16	1 1/4
H-1252	1 5/8	2 3/8	1 3/4	2 1/4	1 5/32	1 11/16	1 1/4
H-1254	1 11/16	2 3/4	1 25/32	2 3/8	1 3/16	1 13/16	1 3/8
H-1256	1 3/4	2 3/4	1 3/4	2 7/16	1 3/16	1 13/16	1 3/8
H-1258	1 13/16	2 7/8	1 3/4	2 1/2	1 1/4	1 31/32	1 7/16
H-1260	1 7/8	3	1 3/4	2 9/16	1 5/16	2 1/16	1 9/16
H-1264	2	3 1/8	1 3/4	2 3/4	1 5/16	2 3/16	1 11/16
H-1266	2 1/16	3 1/8	1 3/4	2 3/4	1 3/8	2 3/16	1 11/16
H-1268	2 1/8	3 1/4	1 3/4	2 15/16	1 7/16	2 3/16	1 13/16
H-1270	2 3/16	3 1/4	1 3/4	2 15/16	1 1/2	2 5/16	1 13/16
H-1272	2 1/4	3 3/8	1 3/4	3 1/8	1 1/2	2 7/16	1 7/8
H-1274	2 5/16	3 1/2	1 3/4	3 1/4	1 5/8	2 9/16	2
H-1276	2 3/8	3 5/8	1 3/4	3 1/4	1 3/4	2 11/16	2 1/8

Fed. Spec: ANSI B107.110

WSH-16TB 16 Piece 3/4" Drive Shallow 12-Point Socket Set with TB-49 Tool Box

WSH-16RC 16 Piece 3/4" Drive Shallow 12-Point Socket Set on Clip Rails

Contents Include:



WSH-16TB

Product Code	Size (Inches)	Product Code	Size (Inches)	Product Code	Size (Inches)	Product Code	Size (Inches)
H-1228	7/8	H-1236	1 1/8	H-1246	1 7/16	H-1256	1 3/4
H-1230	15/16	H-1240	1 1/4	H-1248	1 1/2	H-1258	1 13/16
H-1232	1	H-1242	1 5/16	H-1252	1 5/8	H-1260	1 7/8
H-1234	1 1/16	H-1244	1 3/8	H-1254	1 11/16	H-1264	2

WSH-26RC 26 Piece 3/4" Drive Shallow 12-Point Socket Set on Clip Rails

Contents Include:



WSH-26RC

Product Code	Size (Inches)	Product Code	Size (Inches)	Product Code	Size (Inches)	Product Code	Size (Inches)
H-1224	3/4	H-1238	1 3/16	H-1252	1 5/8	H-1268	2 1/8
H-1226	13/16	H-1240	1 1/4	H-1254	1 11/16	H-1270	2 3/16
H-1228	7/8	H-1242	1 5/16	H-1256	1 3/4	H-1272	2 1/4
H-1230	15/16	H-1244	1 3/8	H-1258	1 13/16	H-1274	2 5/16
H-1232	1	H-1246	1 7/16	H-1260	1 7/8	H-1276	2 3/8
H-1234	1 1/16	H-1248	1 1/2	H-1264	2		
H-1236	1 1/8	H-1250	1 9/16	H-1266	2 1/16		

Features

- SUPERTORQUE® lobular openings for greater turning power without deforming the fastener.
- Designed for quick engagement on both 6 and 12 point fasteners.



3/4" DRIVE

SOCKETS AND DRIVE TOOLS